

# Manitou Springs High School

---



401 El Monte Place

Manitou Springs, CO 80829

Year Built: 1956

Site Area: 19.54 acres

Total Number of Buildings: 2

Number of Detached Buildings: 1 (S.I.L.C. serves both the Middle and High School)

High School: 84,010 SF

SILC: 44,180 SF

CDE Capacity: 704

Current 2024-2025 Enrollment: 367

Grades Served: 9-12

CDE FCI Score: 0.74

Project Summary: Manitou Springs High School is a one-story building consisting of 84,010 SF and is located in Manitou Springs, Colorado. The original school was built in 1956. There have been additions in 1968, 1975 and in 1988. It has administration offices, classrooms, main and auxiliary gym, cafeteria, library, and vocational classrooms. There are additional HS buildings on the campus that are captured separately. The school has additional playing fields. The information was provided by an onsite facility assessment, staff input, and available construction documents.





**MANITOU HIGH SCHOOL**

scale: 1" = 160'-0"

**KEY PLAN LEGEND**

- 1. MANITOU HIGH SCHOOL
- 2. SILC BUILDING
- 3. MANITOU MIDDLE SCHOOL
- 4. COMPETITION FOOTBALL FIELD
- 5. STUDENT AND STAFF PARKING
- 6. TRACK AND FIELD
- 7. STAFF PARKING
- 8. VISITOR PARKING

**SITE PLAN LEGEND**

- SITE BOUNDARY
- BUILDING FOOTPRINT
- PARENT PICK-UP / DROP-OFF LOOP
- BUS PICK-UP / DROP-OFF
- STUDENT ENTRY POINTS
- DISTRICT SERVICE DRIVE / ENTRY

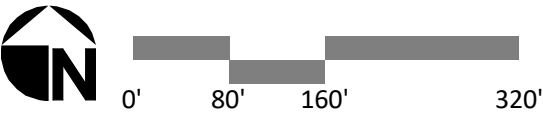



CLASSROOM CAPACITYY					
CLASSROOM	AREA	BUILDING CAPACITY	CDE SF/PUPIL	CDE CAPACITY	SUBTOTAL FUNCTIONAL CAPACITY

Instructional Areas

CLASSROOM	836 SF	24	28	30	24
COM. CENTER	559 SF	15	32	17	15
COMPUTER SCIENCE	377 SF	15	32	12	15
CONSTRUCTION	2053 SF	24	32	64	24
ENGLISH	710 SF	24	28	25	24
ENGLISH	756 SF	24	28	27	24
ENGLISH	712 SF	24	28	25	24
ENGLISH	718 SF	24	28	26	24
ENGLISH	718 SF	24	28	26	24
FRENCH	987 SF	24	37	27	24
HEALTH	1185 SF	24	28	42	24
MATH	879 SF	24	28	31	24
MATH	771 SF	24	28	28	24
MATH	734 SF	24	28	26	24
MATH	747 SF	24	28	27	24
SOCIAL STUDIES	718 SF	24	28	26	24
SOCIAL STUDIES	723 SF	24	28	26	24
SOCIAL STUDIES	726 SF	24	28	26	24
SOCIAL STUDIES	735 SF	24	28	26	24
SPANISH	1689 SF	24	37	46	24
SPANISH	435 SF	24	37	12	24
SPORTS MEDICINE	770 SF	24	37	21	24

Instructional Areas: 22	18537 SF	510		615	510
-------------------------	----------	-----	--	-----	-----

PE/Athletics

ALTERNATE GYMNASIUM	7644 SF	30	0		30
MAIN GYMNASIUM	10617 SF	30	0		30

PE/Athletics: 2	18261 SF	60		0	60
-----------------	----------	----	--	---	----

Science

SCIENCE	1171 SF	24	44	27	24
SCIENCE	1181 SF	24	44	27	24
SCIENCE	1143 SF	24	44	26	24
SCIENCE	860 SF	24	44	20	24

Science: 4	4355 SF	96		99	96
------------	---------	----	--	----	----

Special Education

SPED	530 SF	10	37	14	10
SPED	547 SF	10	37	15	10
SSN	766 SF	10	37	21	10

Special Education: 3	1843 SF	30		50	30
	42996 SF	696		764	696

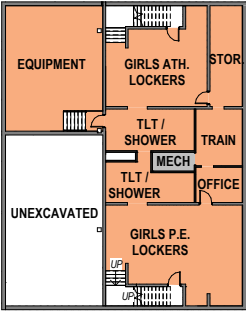

LOWER LEVEL

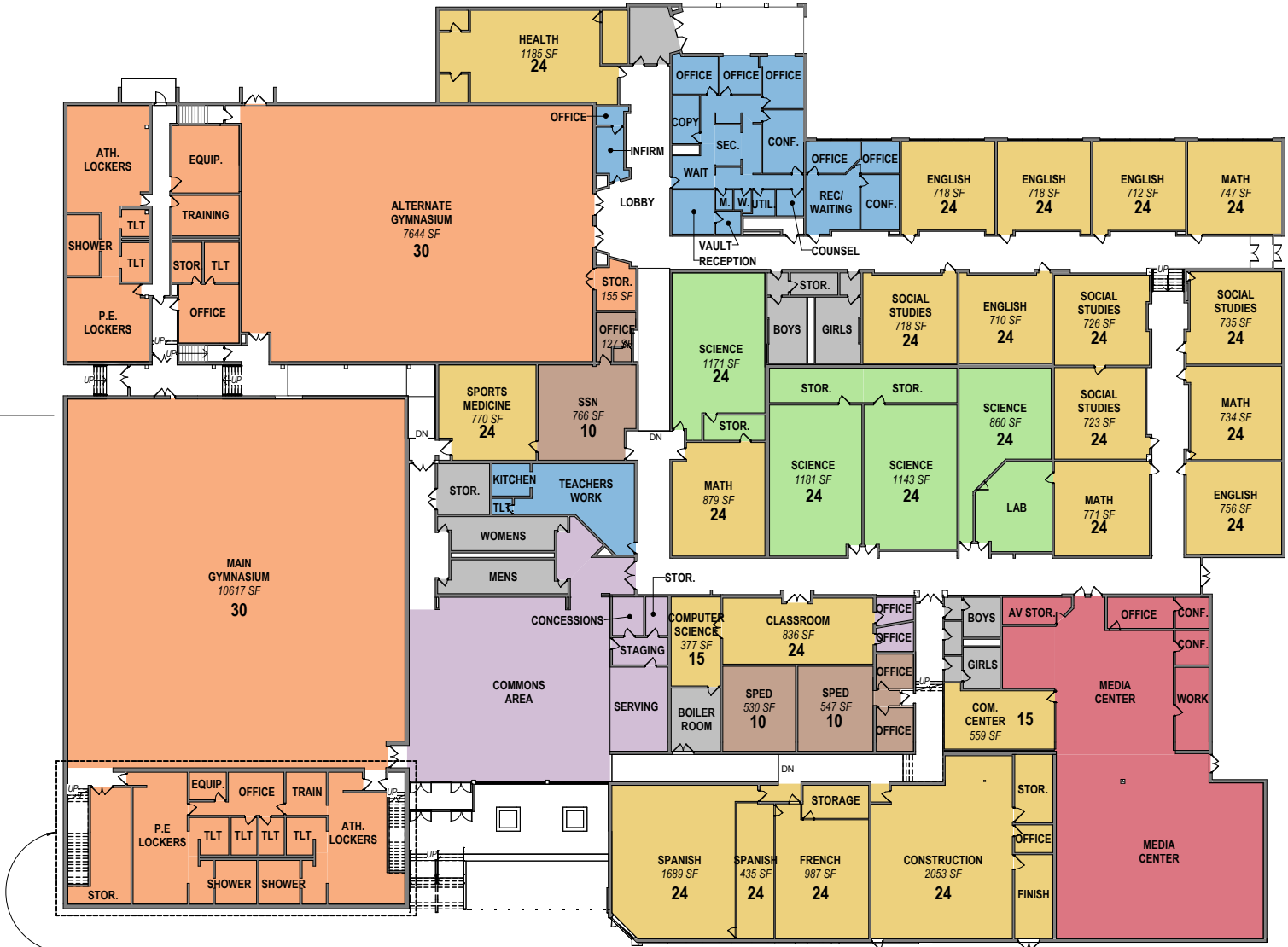

WEIGHT ROOM ABOVE CLASSROOM CAPACITY FLOOR PLAN

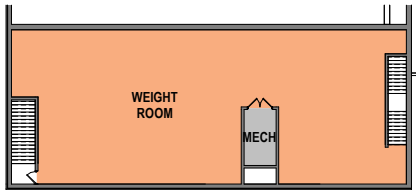

MEZZANINE

EDUCATIONAL DEPARTMENT LEGEND

- ADMINISTRATION
- INSTRUCTIONAL AREAS
- ARTS / CTE
- SCIENCE
- BREAKOUT SPACE
- DINING / COMMONS
- LIBRARY INFORMATION CENTER
- PE / ATHLETICS
- SPECIAL EDUCATION
- SUPPORT / INTERVENTION
- PRE-K

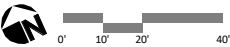

TOTAL FUNCTIONAL CAPACITY WITH SILC = 616

SILC Capacity: 188 Students / 2 (Middle and High School) = 94 Students

TOTAL BUILDING CAPACITY = 696  
TOTAL FUNCTIONAL CAPACITY = 522

Functional capacity of a school must accurately describe the student capacity based on both facility and educational program goals for a specific school. Operational factors are considered including: academic schedule flexibility, teacher academic planning, and bell schedules. The functional capacity factor for middle schools (6/8 PERIODS = 0.75).

CURRENT ENROLLMENT / FUNCTIONAL CAPACITY = 62%  
Current Enrollment (9-12) = 367

CDE recommended classroom size per grade levels:  
9th-12th is 840 SF

Current average classroom sizes:  
9th-12th is 842 SF