



Strasburg School District 31J

Strasburg Elementary School

Programming/Conceptual Design

Design Advisory Group #2

January 27, 2021



Meeting Agenda

1. Agenda / Attendance Sheet
2. DAG Guidelines / Meeting Norms
3. Project Overview
4. Explore Learning Environments
5. Revised Program and Layout
6. Floor Plans
7. Revised Site Plan



DAG Meeting Norms

- Attendance is expected at all scheduled meetings.
- The meetings will start and end on time with duration of **1 hour** (typical).
- Group members should be on time and expect to remain for the entire meeting.
- The purpose of each meeting will be defined; members are requested to come prepared to discuss the topic.
- **The students' interests come first.**
- Committee members will operate and work towards consensus on all issues. All agree to support the solutions and decisions of the group.
- Committee members are requested to focus on solutions that address the needs of Nederland Elementary School as a whole.
- Minutes of each meeting will be distributed by email within one week of meeting date.
- All members are to speak up in an open forum- all points of view will be heard and valued.
- All participants will be treated with mutual respect.
- Members of the committees will operate on a first name basis.



Project Overview

Excerpt from Selected Masterplan Option B 07.28.2020 →

Masterplan Scope of Work: Strasburg Elementary School

- Build 8 elementary school classrooms (9,200 sf Addition)
- Add 45,000 sf playground area for grades 2-5
- 55,000 sf of paving to create safe bus and parent drop off areas
- 50,000 sf of gravel parking area for staff and visitors
- Build a shared gymnasium for elementary school and high school students
- Improve security with corridor connection

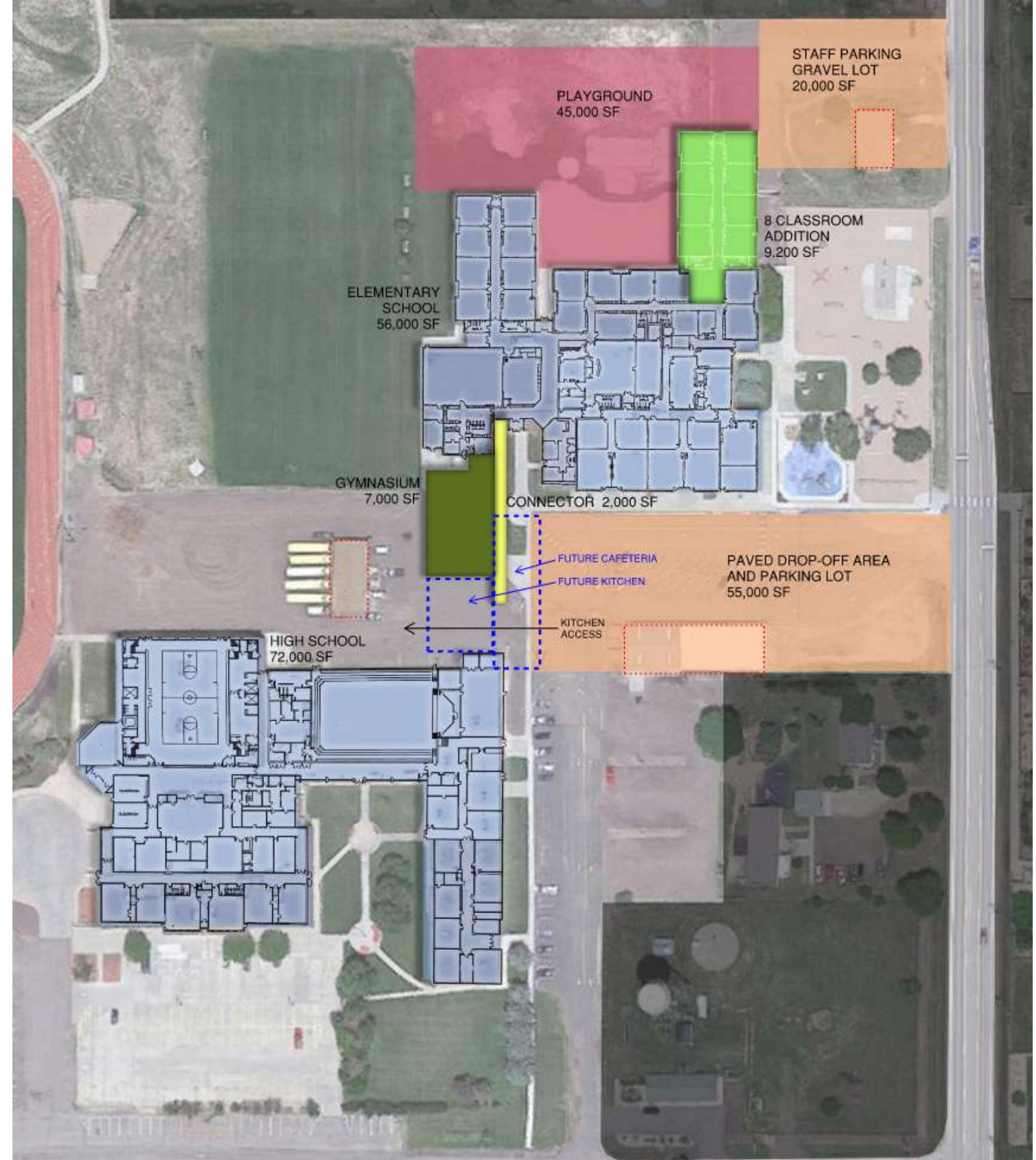

Project Overview

Renovation/Addition Area Break-Down

8,875 SqFt	Gym addition with restrooms and storage
9,650 SqFt	Classroom addition
8,261 SqFt	Level 1 renovation (finishes only)
7,000 SqFt	Level 2 renovation (finishes and new openings, new walls ex. library/multi-purpose room)
16,600 SqFt	Level 3 renovation (complete renovation)
23,000 SqFt	No renovations (4th and 5th classrooms, music rm, kitchen, faculty rooms)



Program Overview

Strasburg Elementary School		EXISTING						PROPOSED (2026)					
		NUMBER SIMILAR ROOMS	NET AREA	TOTAL AREA	TEACHER STATIONS	STUDENTS PER STATION	TOTAL STUDENTS	NUMBER SIMILAR ROOMS	NET AREA	TOTAL AREA	TEACHER STATIONS	STUDENTS PER STATION	TOTAL STUDENTS
DEPARTMENT / PROGRAM													
ACADEMIC CORE													
	PRE-SCHOOL W STORAGE AND RR	3	950	2,850	6	15	90	4	1200	4,800	4	20	80
	KINDERGARTEN	3	920	2,760	3	25	75	5	920	4,600	4	25	100
	1ST GRADE	4	820	3,280	4	25	100	5	820	4,100	5	25	125
	2ND GRADE	4	840	3,360	4	25	100	5	840	4,200	5	25	125
	3RD GRADE	3	920	2,760	3	25	75	5	920	4,600	5	25	125
	4TH GRADE	3	800	2,400	3	25	75	4	800	3,200	5	25	125
	5TH GRADE	3	800	2,400	3	25	75	4	800	3,200	5	25	125
ACADEMIC SUPPORT													
	INTERVENTION SPACE	4	412	1,648				4	0	0			
	STUDENT HEALTH PROFESSIONAL	0	0	0				1	300	300			
	TEACHER WORK ROOM	1	209	209				1	0	209			
	STORAGE/RESOURCE MATERIALS	9	0	867				9	0	867			
	FULL TIME COUNSELOR	1	800	800				1	200	200			
	BOCES	2	750	1,500				0	0				
				0									
TOTAL ACADEMIC CORE				24,834			590			30,276			805
SPECIAL EDUCATION													
	SPECIAL ED CLASSROOM	2	630	1,260				2	630	1,260			
	OFFICE	0	0	0				1	200	200			
	OT/PT	0	0	0				0	0	0			
TOTAL SPECIAL EDUCATION				1,260						1,460			



Program Overview

Strasburg Elementray School		EXISTING					PROPOSED (2026)					
		NUMBER SIMILAR ROOMS	NET AREA	TOTAL AREA	TEACHER STATIONS	STUDENTS PER STATION	TOTAL STUDENTS	NUMBER SIMILAR ROOMS	NET AREA	TOTAL AREA	TEACHER STATIONS	STUDENTS PER STATION
DEPARTMENT / PROGRAM												
FINE ARTS												
	ART ROOM	1	918	918			1	918	918			
	MUSIC ROOM/STAGE	1	1544	1,544			1	1544	1,544			
	MUSIC OFFICE /STORAGE	0	0	0			0	0	0			
TOTAL FINE ARTS		2,462					2,462					
DINING / COMMON												
	STAGE	1	3725	3,725			1	3725	3,725			
	KITCHEN	1	1982	1,982			1	1982	1,982			
	CAFETERIA	1	3514	3,514			1	3514	3,514			
	CAFETERIA STORAGE	1	220	220			1	220	220			
TOTAL DINING / COMMON		9,441					9,441					
LIBRARY / TECHNOLOGY												
	MEDIA CENTER	1	1994	1,994			1	3204	3,204			
	COMPUTER LAB	1	1100	1,100			0	0	0			
TOTAL LIBRARY / TECHNOLOGY		3,094					3,204					
PE AND ATHLETICS												
	GYM	0	0	0			1	4500	4,500			
	GYM STORAGE	0	0	0			1	200	200			
TOTAL PE AND ATHLETICS		0					4,700					



Program Overview

Strasburg Elementray School		EXISTING					PROPOSED (2026)					
		NUMBER SIMILAR ROOMS	NET AREA	TOTAL AREA	TEACHER STATIONS	STUDENTS PER STATION	TOTAL STUDENTS	NUMBER SIMILAR ROOMS	NET AREA	TOTAL AREA	TEACHER STATIONS	STUDENTS PER STATION
ADMIN & STUDENT SERVICES												
	RECEPTION/WAITING AREA	1	504	504			1	504	504			
	PRINCIPALS OFFICE	1	219	219			1	219	219			
	ITINERANT OFFICE	1	128	128			1	128	128			
	TEACHER BREAK ROOM	1	450	450			1	450	450			
	LACTATION ROOM	0	0	0			?	0	0			
	CLINIC W/HC RESTROOM	1	88	88			1	88	88			
	CONFERENCE ROOM	1	205	205			1	205	205			
	SECURE STORAGE	1	84	84			1	84	84			
	COMMUNITY STORAGE / TABLE CHAIR	1	185	185			1	185	185			
TOTAL ADMINISTRATION		1,863					1,863					
TOTAL ASSIGNABLE AREAS				42,954					53,616			
UNASSIGNABLE												
TOTAL UNASSIGNABLE				10,739					13,404			
UNASSIGNABLE % OF ASSIGNABLE AREA				25.0%					25.0%			
SUMMARY												
TOTAL GROSS BUILDING AREA				53,693					67,020			
STUDENT CAPACITY												
BASED ON TOTAL CAPACITY				518 STUDENTS					650 STUDENTS (2026 projection)			



ENJOYABLE ACTIVITIES

dopamine naturally enhances learning and reduces the secretion of stress hormones

FUN + CHALLENGING

effective approaches combine FUN with progressively increasing CHALLENGES

MOVEMENT IMPROVES LEARNING

increases pre-frontal cortex activity, which builds cognitive ability

THE WHOLE CHILD

SOCIAL & EMOTIONAL development accelerates achievement



A child's INTERNAL MOTIVATION is one of the most powerful tools for learning.

Multi-modal Learning



a space for the

ANALYST



a space for the

**PROBLEM
SOLVER**



a space for the

TECHNOLOGIST



a space for the

NATURALIST

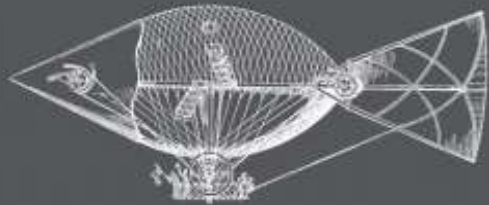

a space for the

MAD SCIENTIST



a space for the

ADVENTURER



a space for the

MULTI-TASKER



a space for the

VISIONARY

“For students to thrive, they need a learning environment that engages and challenges them to reach their individual potential.”



TYPES OF BREAK-OUT

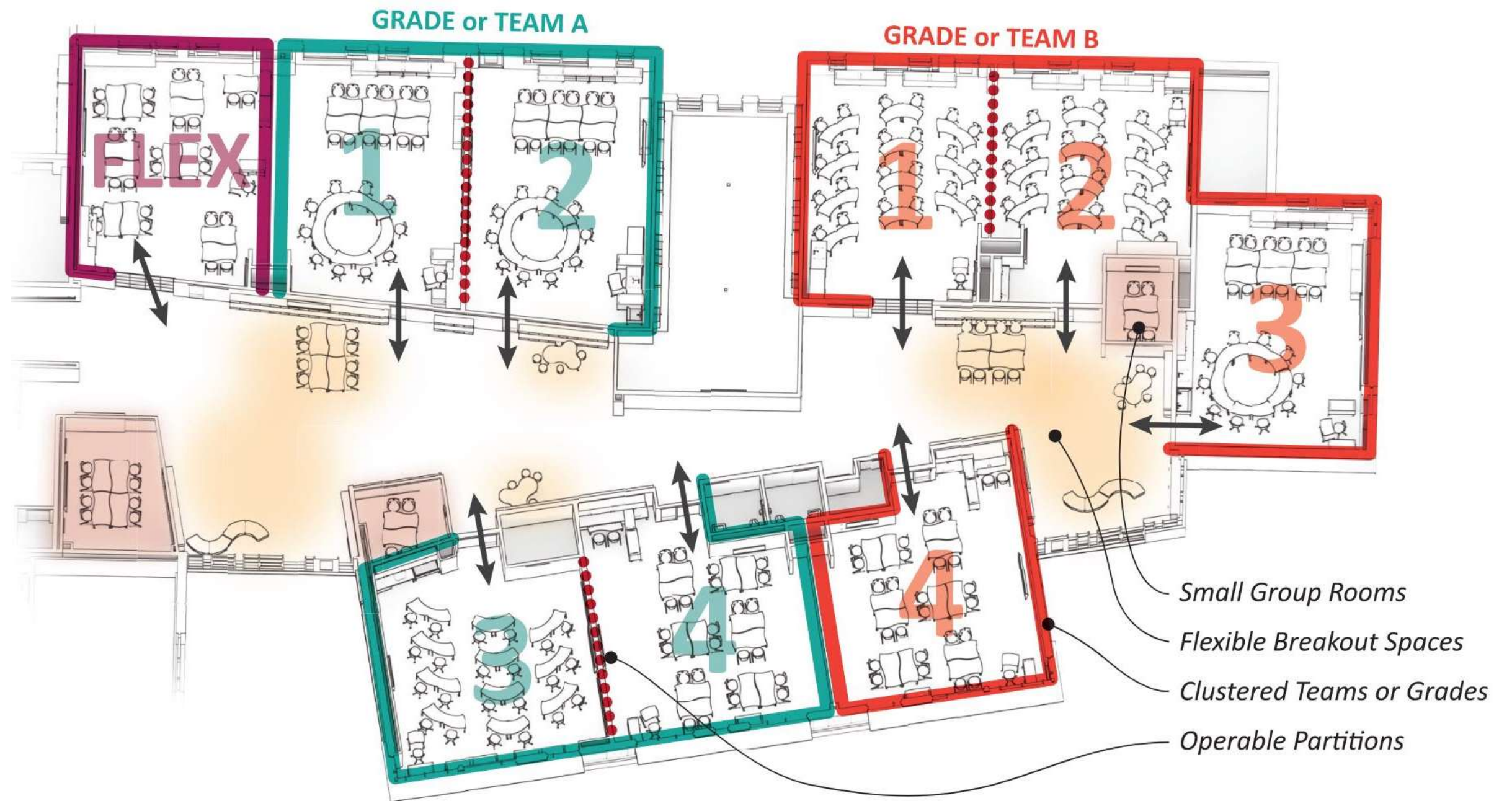

Example - Douglass Elementary

BREAK-OUT



BREAK-OUT



BREAK-OUT

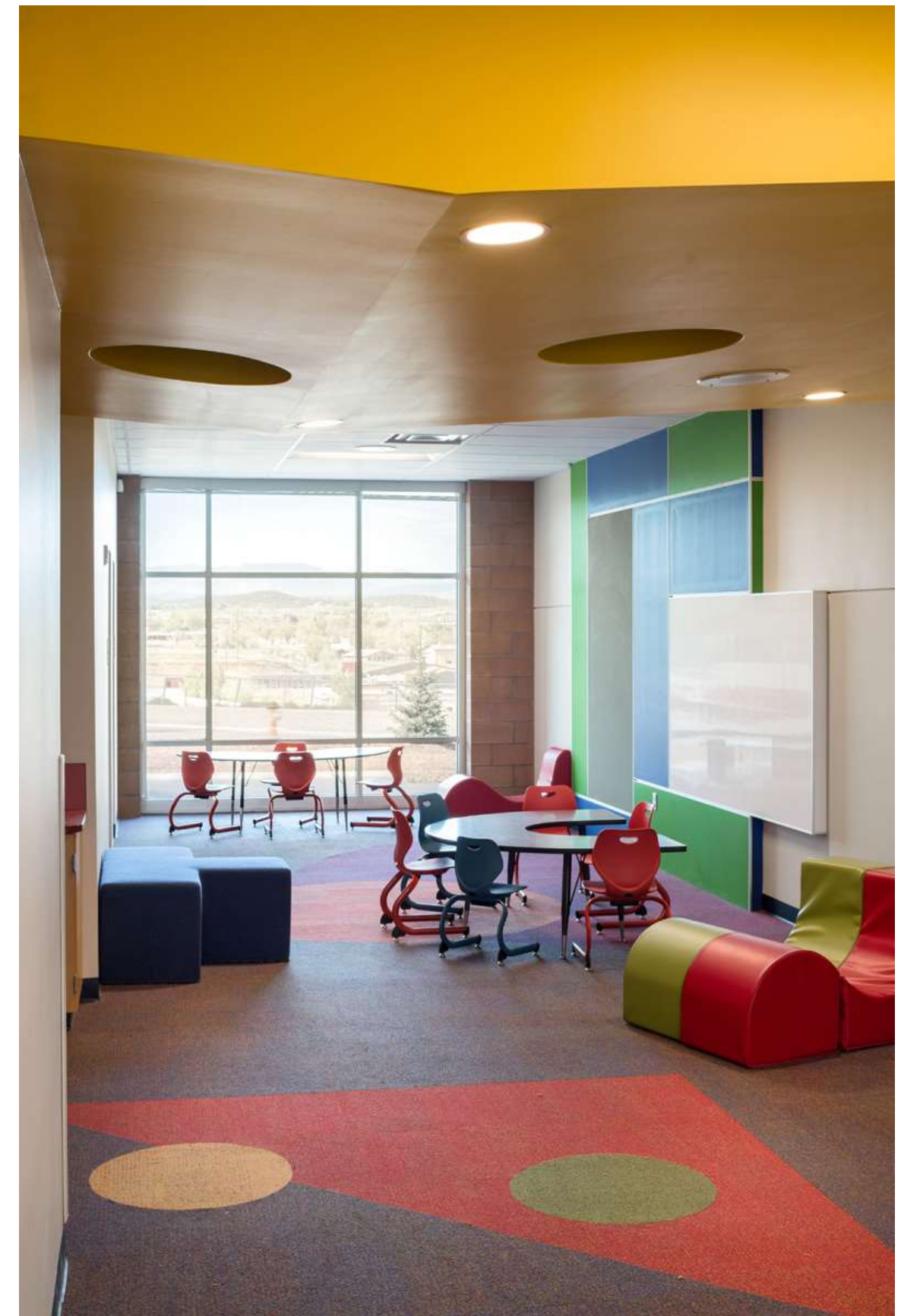

BREAK-OUT



MAKER / S.T.E.A.M



MAKER / S.T.E.A.M



MAKER / S.T.E.A.M



Art Patio



MEDIA CENTER



SECURE VESTIBULE



Program Organization #3

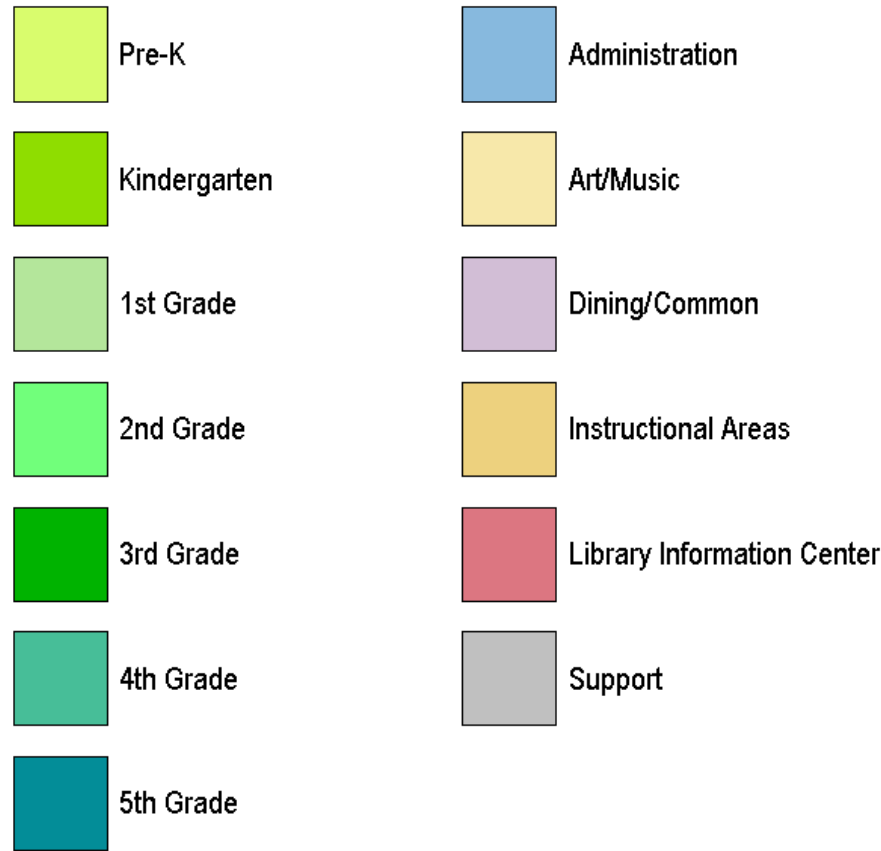

- Pre-K adjacent to east playground with daylight
- Kindergarten close to admin
- Grades 1-5 clustered in groups with **break-out** learning areas dispersed throughout the building
- Large central media center
- Art room moved to north with outdoor access and north natural daylight
- Administration remains in same location with addition of a secure entry
- Outdoor dining area near cafeteria



Code Considerations

- Current building code (IBC 2015) area limit for school buildings *without* sprinkler systems = **25,375 sf**
- Total current building area = **53,700 sf**
(existing non-conforming but we can't make it worse)
- School buildings without sprinkler systems must be broken up into fire areas no greater than 12,000 sf using 2 hour **rated walls**
- Gym and classroom additions will be built as separate buildings using **fire wall** construction techniques

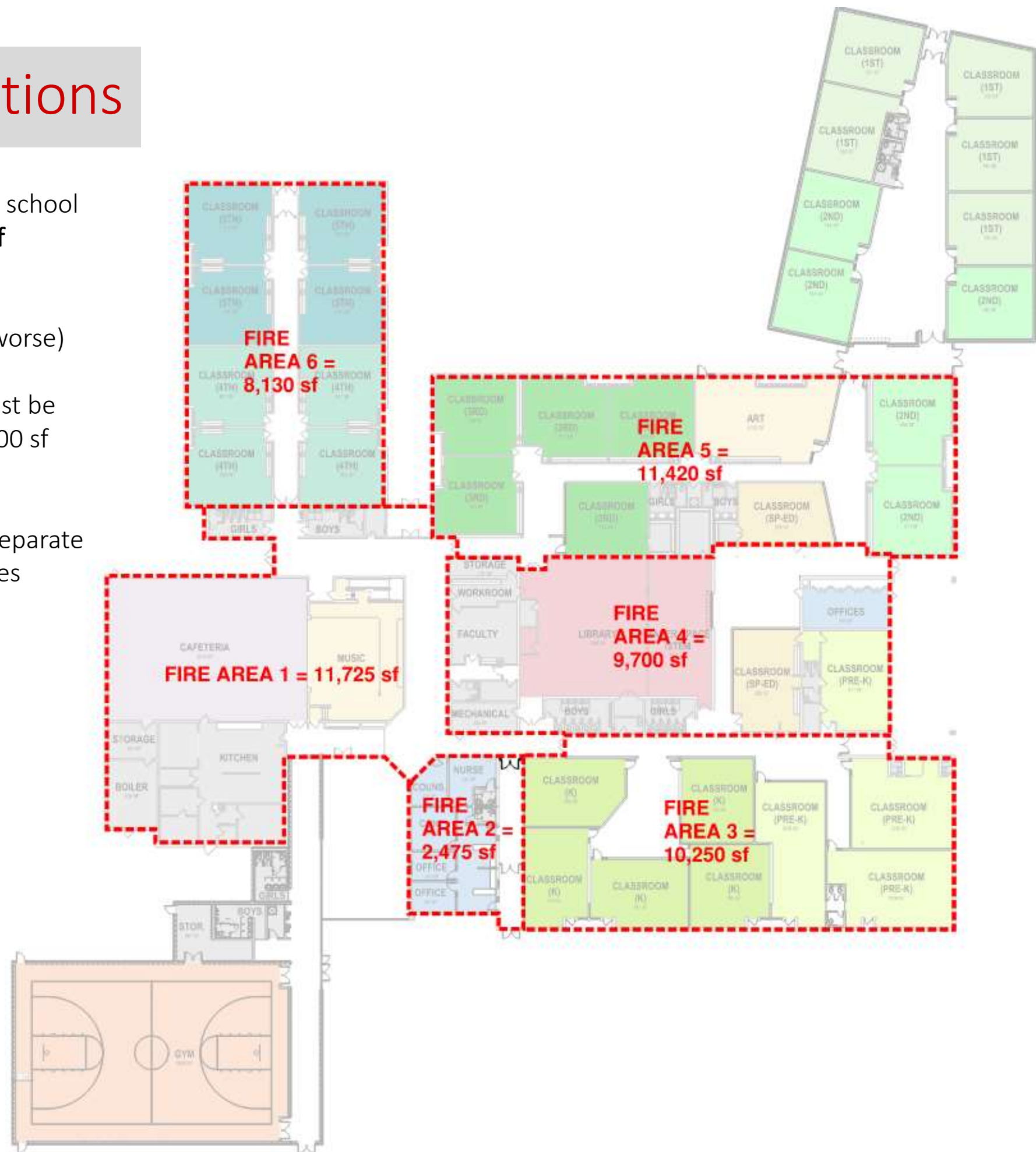

Overall Floor Plan

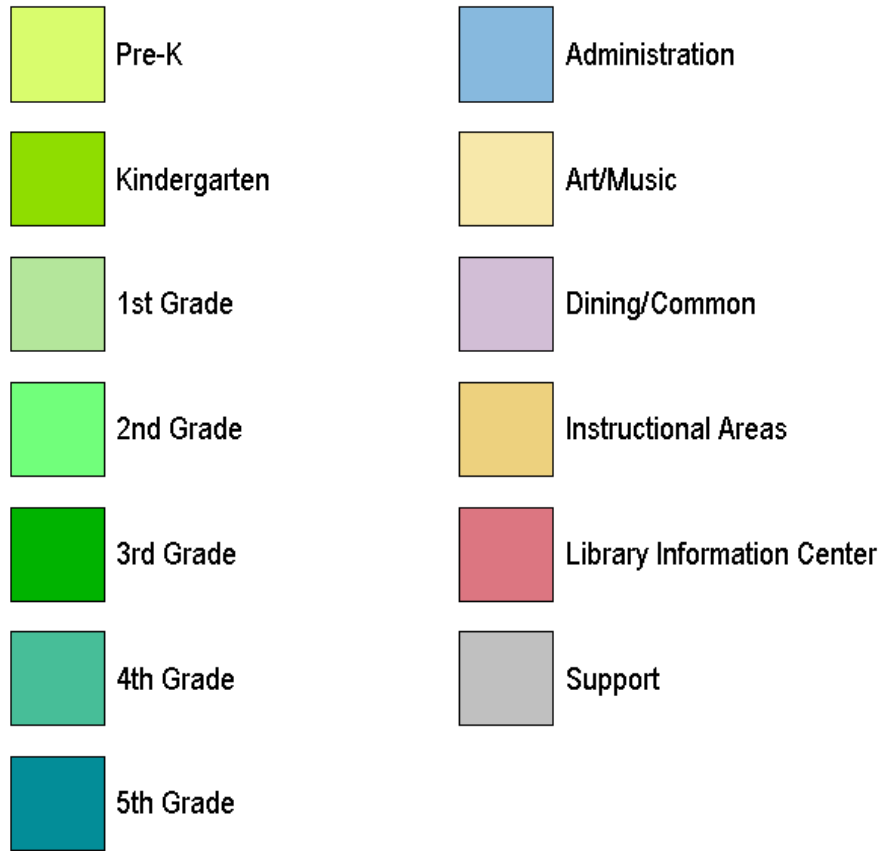

Gym Addition / Admin

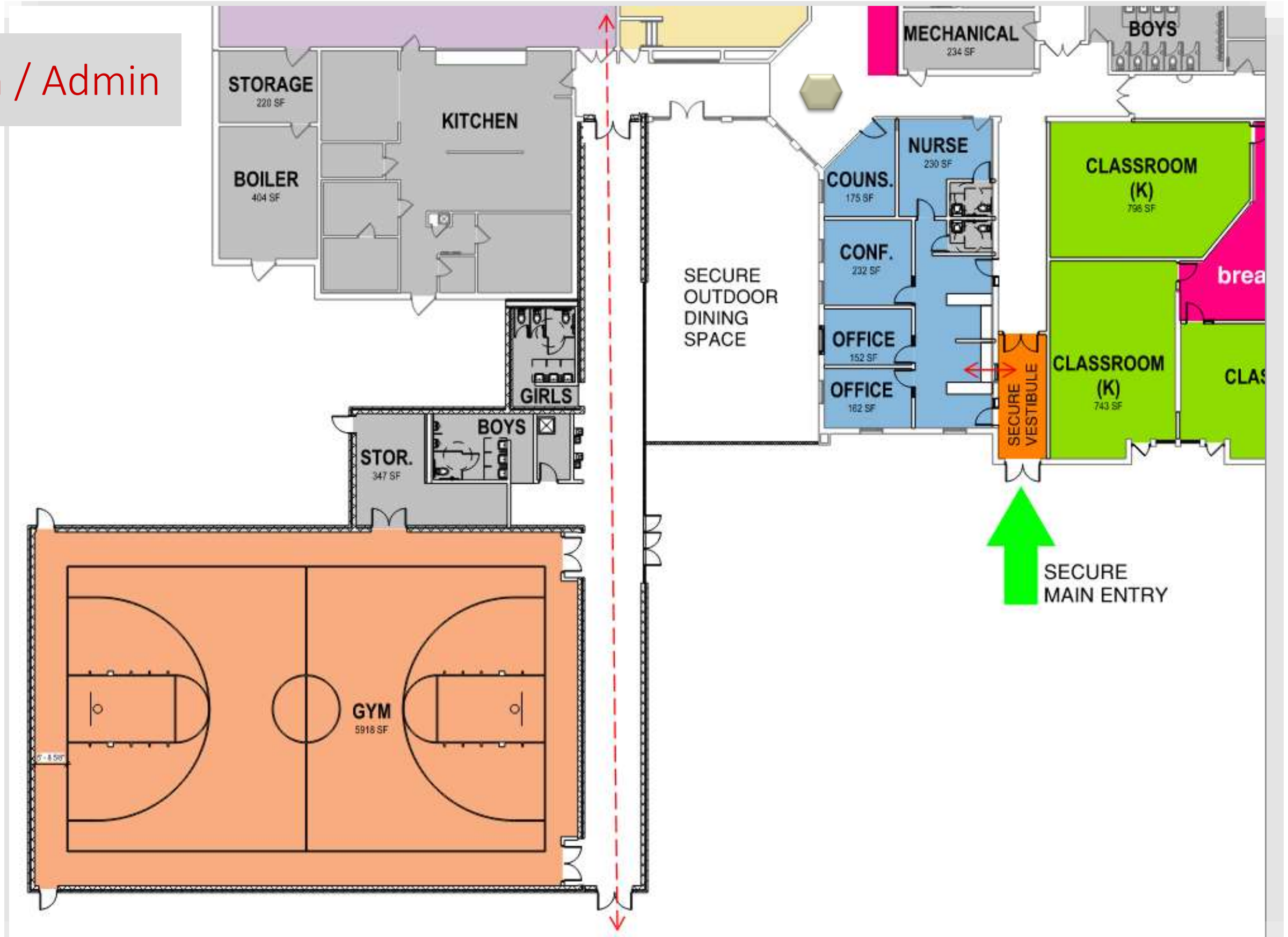

Kinder / Pre-K / Library





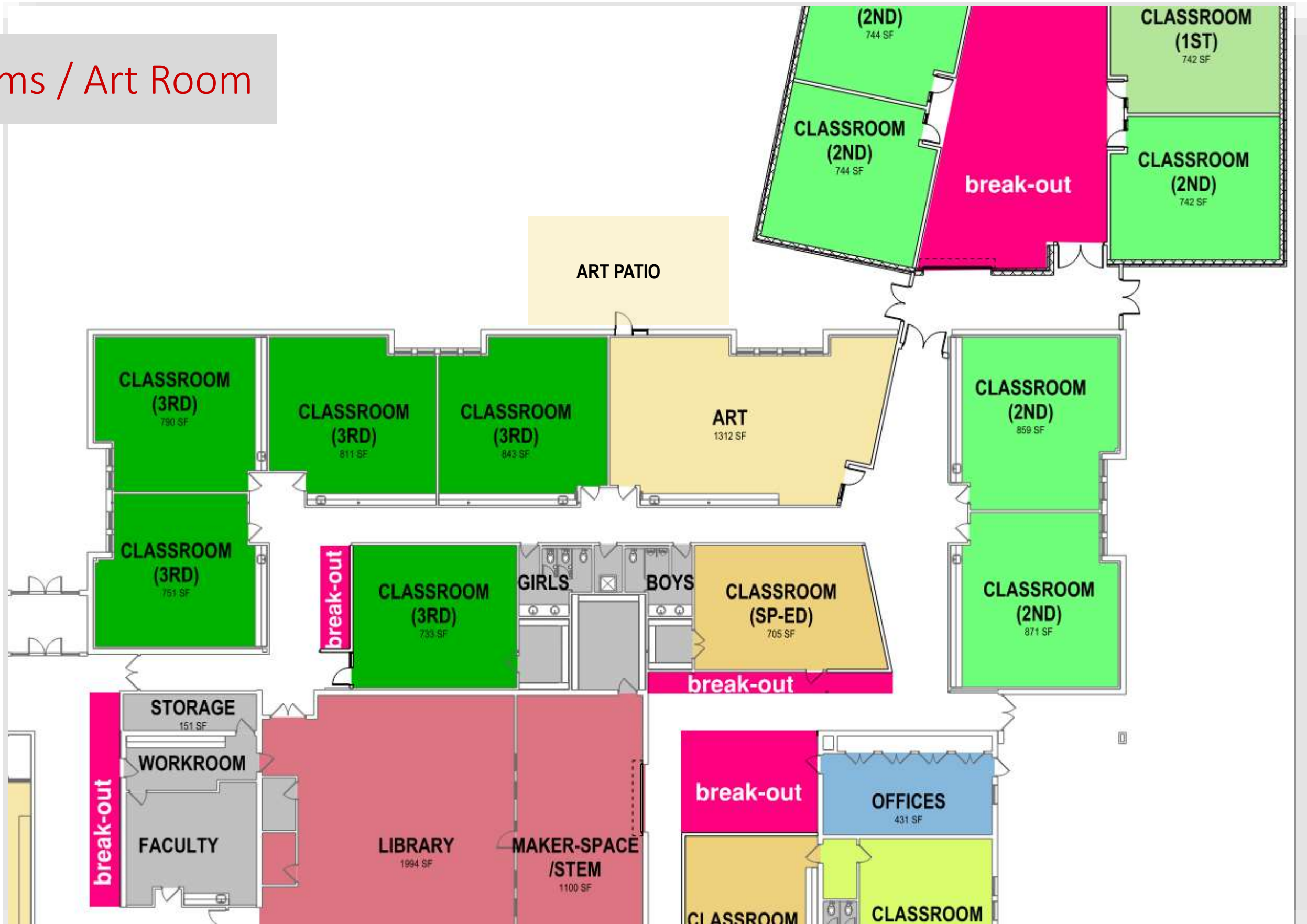









Classrooms / Art Room



Classroom Addition



Site Option C

	Pre-K		Administration
	Kindergarten		Art/Music
	1st Grade		Dining/Common
	2nd Grade		Instructional Areas
	3rd Grade		Library Information Center
	4th Grade		Support
	5th Grade		

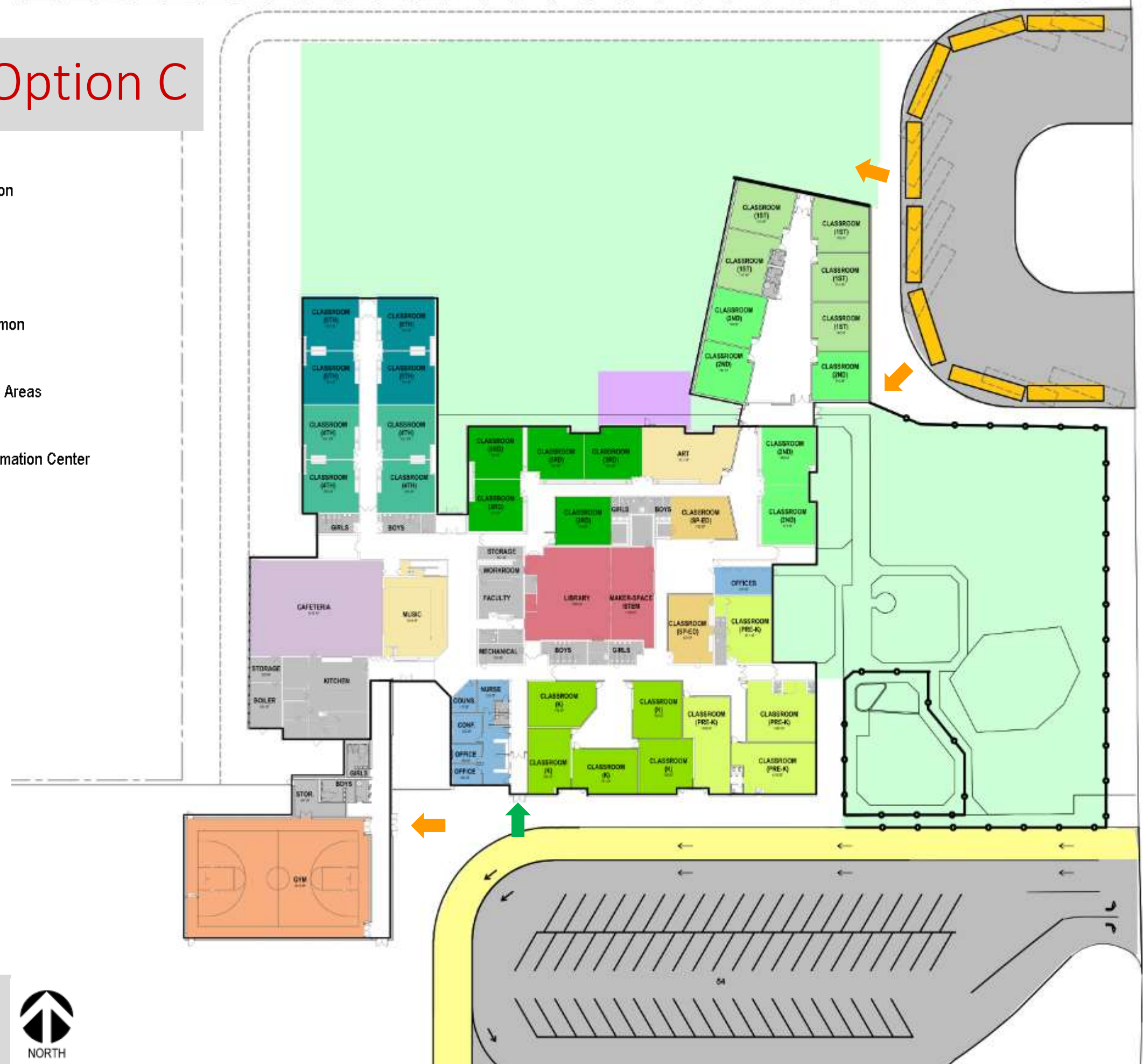

Site Option C

- Separate bus drop off areas for high school and elementary school
- Kitchen delivery moved north if/when connector is constructed
- Elementary school bus drop off is adjacent to playgrounds
- Room for 8-10 buses at elementary, 7-10 buses at high school depending on parking/stacking method.
- East playground shrinks to accommodate bus loop



Wrap Up

Next Meeting

February 11th - 3:20-4:20



Thank You!



www.rtaarchitects.com

