



## School Facilities Digital Open House

### *Proposed Improvement Projects*

# Lake School - Pre-K & Kindergarten

---

**Overview of Needs:** Renovated in 2009, the Lake School functions very well and generally meets the needs of the students and community. The facility houses the Pre-school and Kindergarten programs and includes District Administration offices. The facility has the ability to accommodate enrollment projections into the future, however, there are safety, program, and maintenance improvements that have been identified as deficient. The following projects are planned:

**Safety:** Improvements to increase the visibility from the administration and reception area to better monitor visitors coming to the facility are included in the project. The entry vestibule will also be improved with a new transaction window, electronic locks, and door hardware consistent with other proposed vestibule improvements across the district.

**Safety:** To address the need for improved vehicular and pedestrian circulation, upgrades to the parking lot and student drop-off lane are proposed. These alterations provide safer dedicated pedestrian routes to the school entry, improve student drop-off lanes, and provide dedicated parking for walk-in preschool student check-in. The sidewalk along Boulevard Street is extended South to Arthur Avenue to increase the bus drop-off length and connect the school site to the surrounding community and the Safe Route to School.

**Safety & Maintenance:** Other exterior improvements are planned including upgrading the playground surfacing from wood chips to a poured rubber surface. Seasonal shade structures are needed at the playgrounds to meet code and provide improved spaces for outdoor activities.

*Explore the plans below to see what relevant, exciting, and important improvements are proposed for the Lake School!*



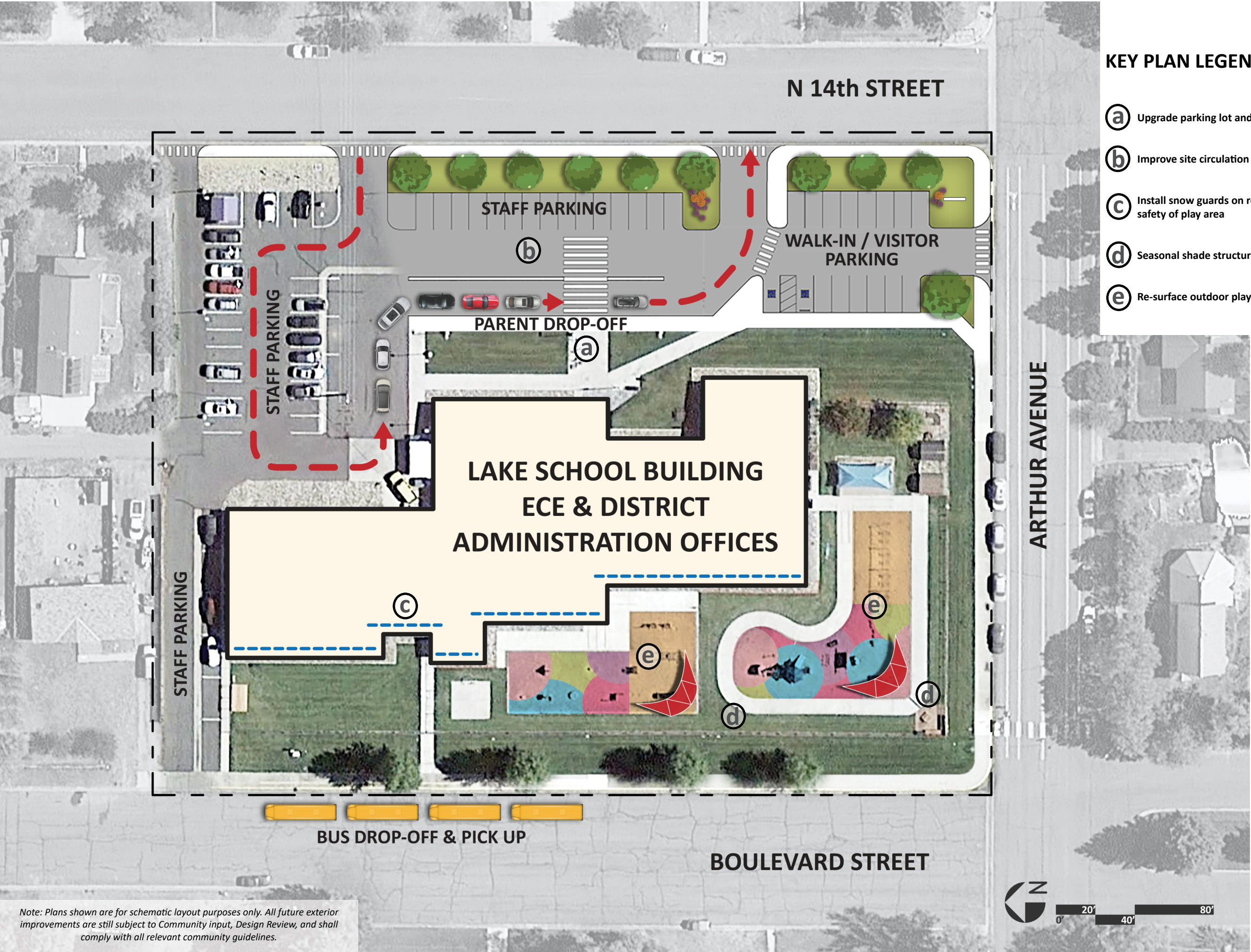

Note: Plans shown are for schematic layout purposes only. All future exterior improvements are still subject to Community input, Design Review, and shall comply with all relevant community guidelines.



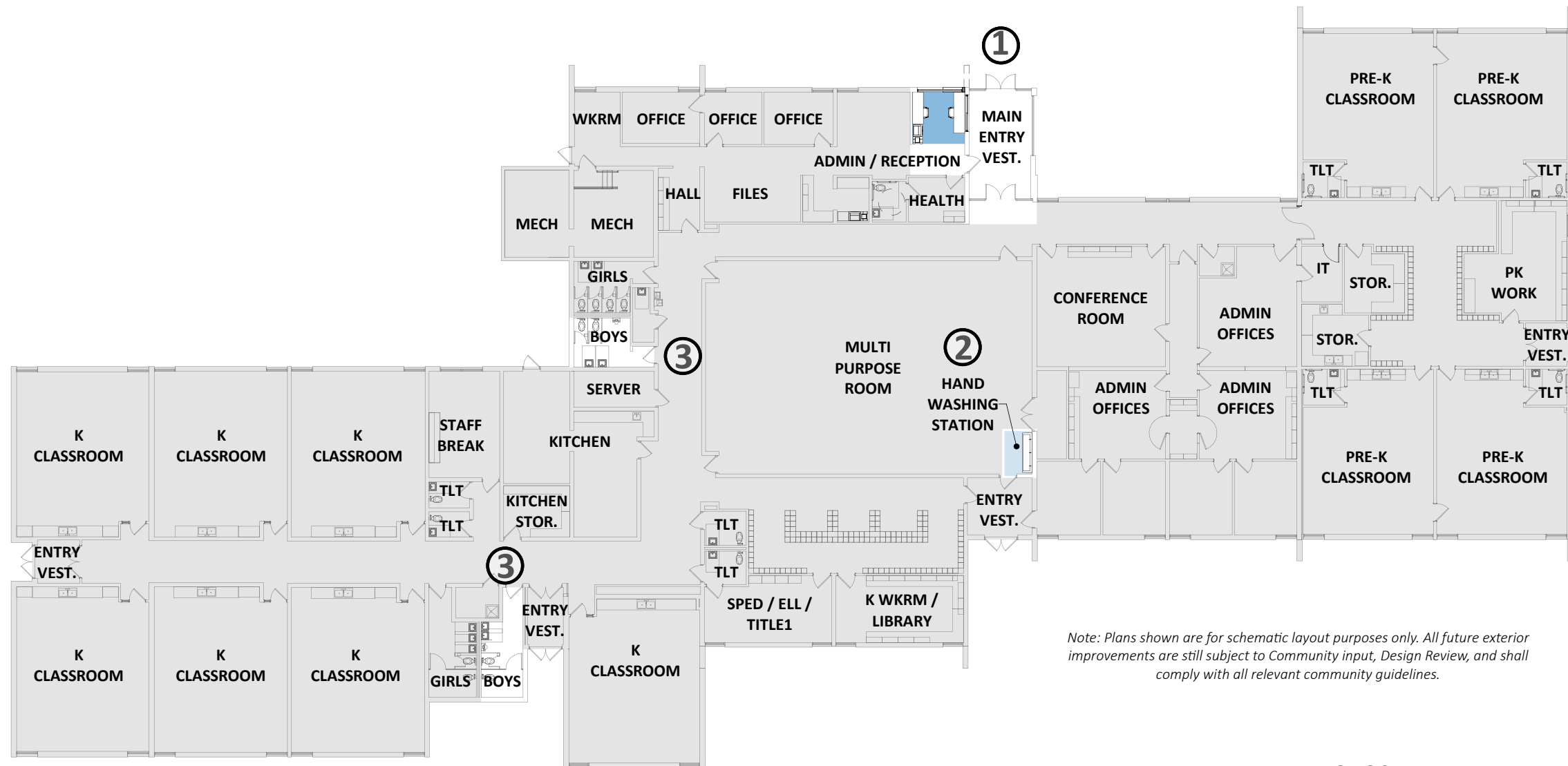

## GRAPHIC LEGEND

- ADMINISTRATION & STUDENT SERVICES
- SUPPORT SPACE
- NOT IN SCOPE
- NEW WALL
- EXISTING WALL

## KEY PLAN LEGEND

- 1 Secure Vestibule Upgrades
- 2 Add Handwash Station
- 3 Privacy Improvements to Restrooms

*Note: Plans shown are for schematic layout purposes only. All future exterior improvements are still subject to Community input, Design Review, and shall comply with all relevant community guidelines.*

PROPOSED PLAN - LEVEL 1

# Lake School - Pre-K & Kindergarten

## Proposed Site Improvements

*Reference Proposed Site Plan for additional information.*

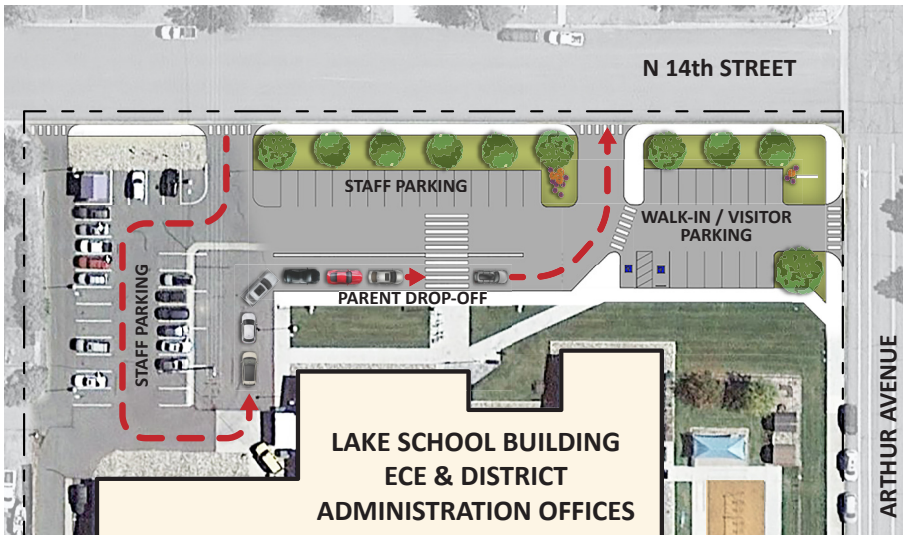

### **a** PARENT DROP-OFF/PICK-UP

To reduce congestion in the existing parking lot, the site circulation will be reconfigured to improve traffic flow and locate parent drop off near the main building entrance. The improvements will better accommodate parents walking their students into the building, improve capacity for dropping off at the front door and create better connections to the safe routes to school sidewalks.



### **b** PARKING LOT

Reconfigure the parking lot to improve site circulation for cars and pedestrians. This re-stiping will increase the number of parking spaces and better accommodate needs at this facility.

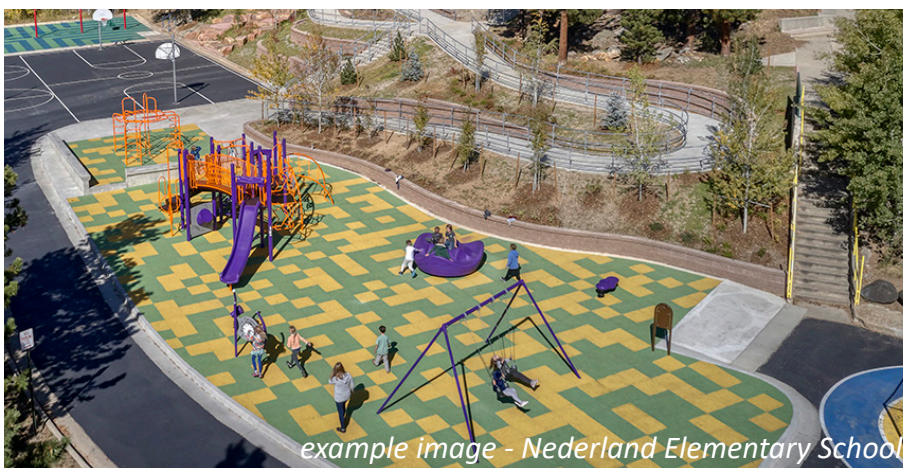

*example image - Nederland Elementary School*

### **c** RESURFACE PLAYGROUND

Replace existing wood chips with poured rubber fall protection to reduce maintenance and improve safety of the playground and surrounding space. Selected pieces of playground equipment will be replaced we new equipment to expand offerings and improve accessible options for disabled students.





## Lake School - Pre-K & Kindergarten



### **d** SEASONAL SHADE STRUCTURE

A seasonal shade structure to help shade the guests, students and staff from the sun when necessary but can be removed when the sun is welcoming.



### **e** SNOW GUARDS

Snow guards and snow melt systems will be installed to prevent snow and ice pack from avalanching, reducing hazards to people and damage property below.



# Lake School - Pre-K & Kindergarten

## Proposed Building Improvements

*Reference Proposed Building Plan for additional information.*

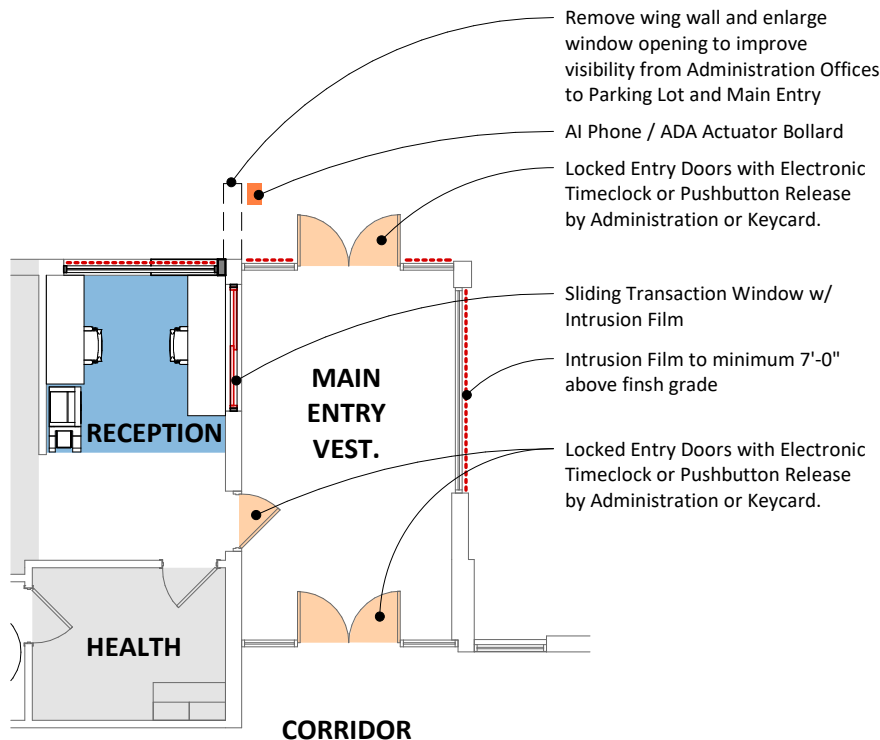

### ① SECURE ENTRY VESTIBULE

The entry will be modified to accommodate district standards for safety and security. Intrusion resistant film will be applied to the glass surrounding the reception to resist forced entry. An audio / video doorbell will be installed at the entry to control who is able to enter the school from the exterior. A new electronic door locking system will allow staff to check visitor credentials before allowing the visitors to gain access to the building. Visual control of the building administration will be improved.



### ② HAND WASH STATION

To encourage good sanitation practices and improve student health, new hand washing stations will be installed throughout the school.



### ③ PRIVACY SCREEN IN RESTROOMS

New urinal screens are to be installed where needed to improve privacy and sanitation.

