

CAÑON CITY MIDDLE SCHOOL

Design Advisory Group Meeting 4

September 18, 2018



Meeting Agenda

1. Agenda / Attendance Sheet
2. Review Graphic Space Program
3. Site Analysis
4. Site Parti Diagrams
5. Closing

Meeting Norms

- Attendance is expected at all scheduled meetings.
- The meetings will start and end on time with duration of **1-1/2 hours** (typical). Group members should be on time and expect to remain for the entire meeting.
- The purpose of each meeting will be defined; members are requested to come prepared to discuss the topic.
- The students' interests come first.
- Committee members will operate and work towards consensus on all issues. All agree to support the solutions and decisions of the group.
- Committee members are requested to focus on solutions that address the needs of Canon City Schools as a whole.
- Committee meetings will stay on task.
- Discussion, evaluation, and decisions will be research and data based guided by district's mission statement.
- Minutes of each meeting will be distributed by email within one week of meeting date.
- All members are to speak up in an open forum- all points of view will be heard and valued.
- All participants will be treated with mutual respect.
- Members of the committees will operate on a first name basis.
- Snacks and Refreshments will be served at all meetings to give "energy boost."

ADMIN & STUDENT SERVICES

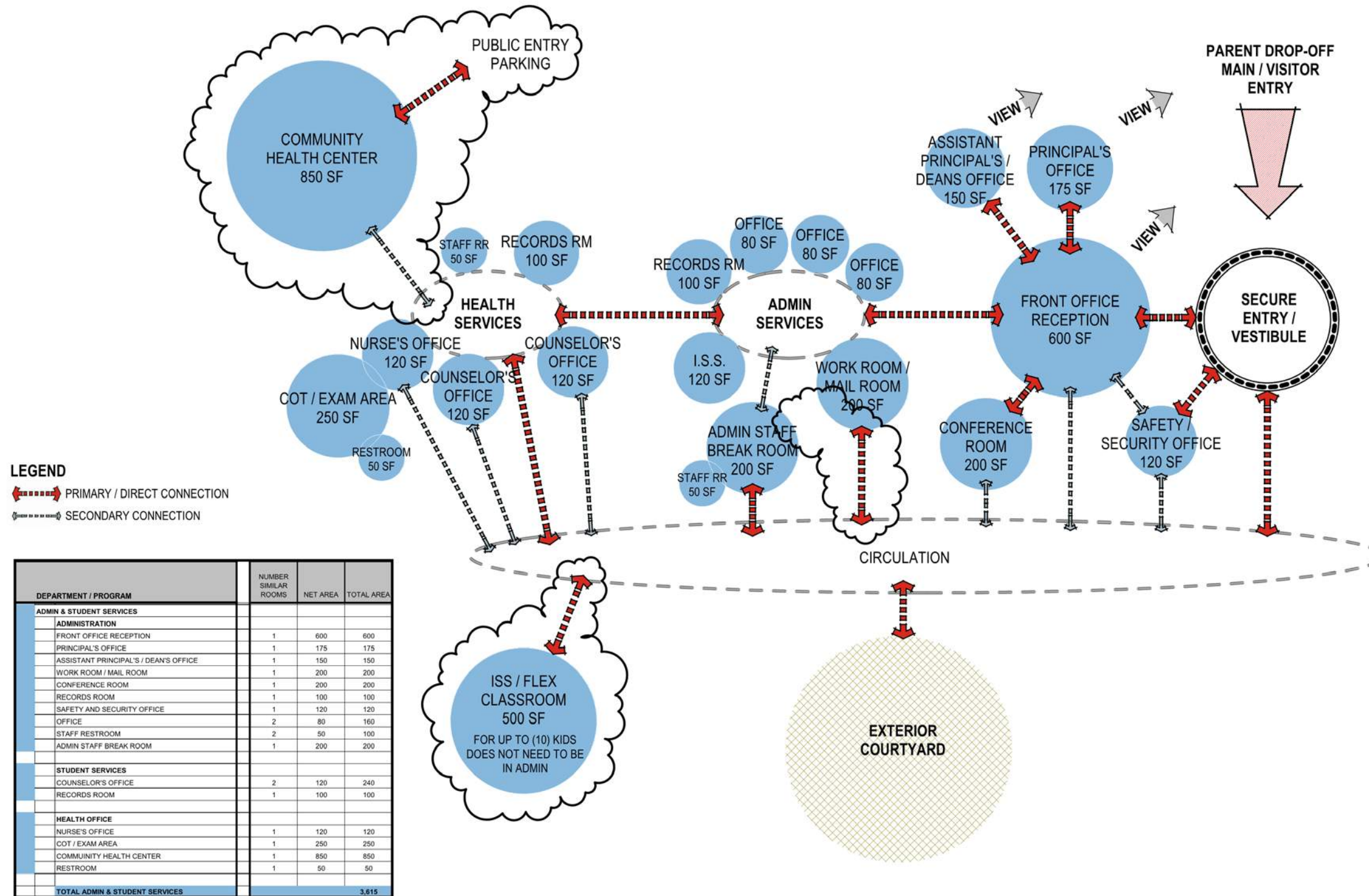

STUDENT COMMONS / DINING

LEGEND

- PRIMARY / DIRECT CONNECTION
- SECONDARY CONNECTION

DEPARTMENT / PROGRAM	NUMBER SIMILAR ROOMS	NET AREA	TOTAL AREA
STUDENT COMMONS / DINING			
DINING COMMONS			
DINING COMMONS PERFORMANCE	1	3,500	3500
PERFORMANCE PLATFORM / STAGE	1	1,000	1000
DRAMA STORAGE	1	200	200
DRESSING ROOMS	2	120	240
KITCHEN			
KITCHEN / SERVING	1	1,200	1200
DISH RETURN / WASH	1	300	300
STAFF RESTROOM / LOCKER	1	150	150
TOTAL STUDENT COMMONS / DINING			6,590

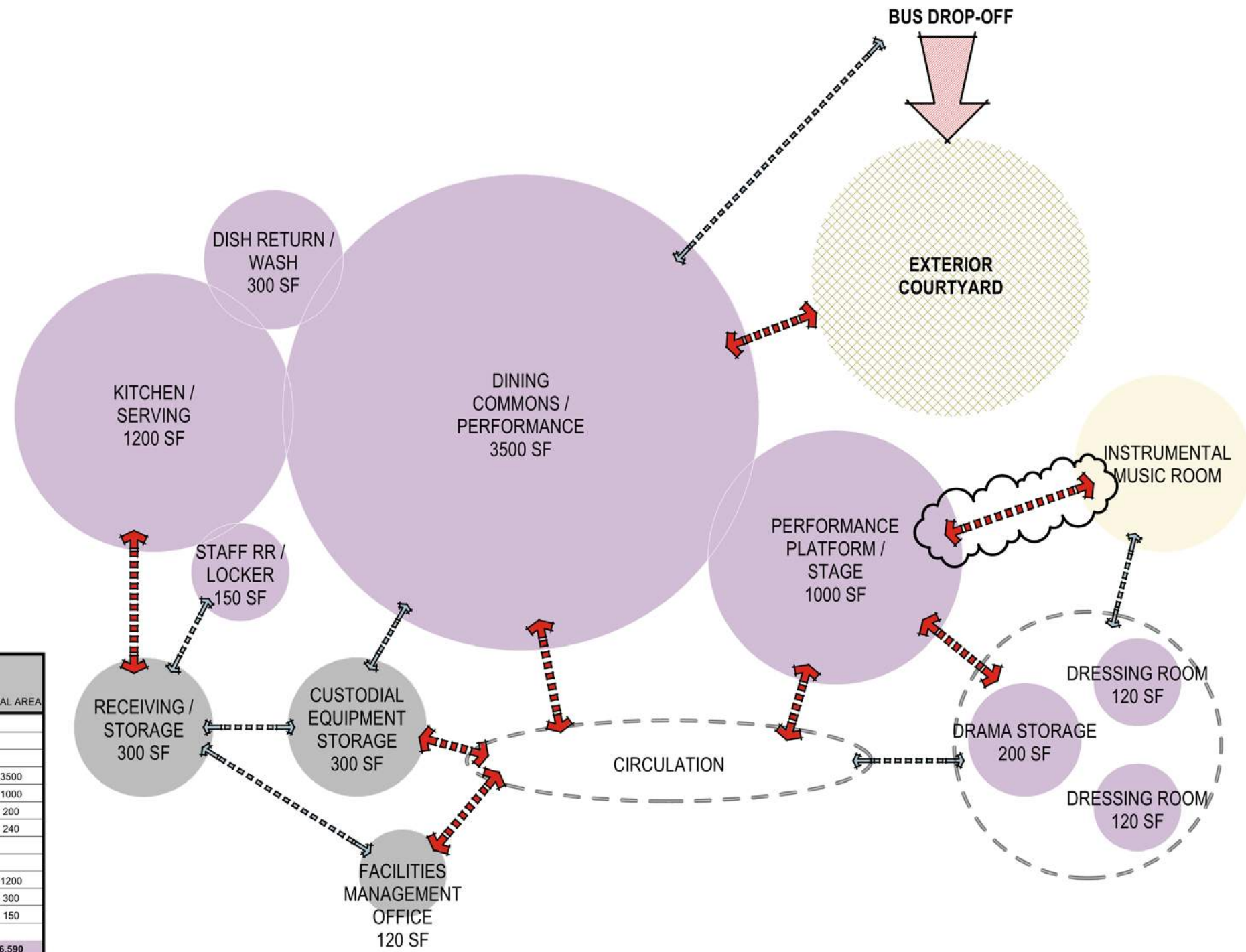

CLASSROOM ORGANIZATION BY SUBJECT

LEGEND

-  PRIMARY / DIRECT CONNECTION
-  SECONDARY CONNECTION
-  READING & WRITING
-  SOCIAL STUDIES & MATH
-  SCIENCE

DEPARTMENT / PROGRAM	NUMBER SIMILAR ROOMS	NET AREA	TOTAL AREA
ACADEMIC CORE			
6TH GRADE CLASSROOMS			
6TH GRADE - READING AND WRITING	2	850	1700
6TH GRADE - SOCIAL STUDIES AND MATH	2	850	1700
SCIENCE LAB	1	1,000	1000
7TH GRADE CLASSROOMS			
7TH GRADE - READING AND WRITING	2	850	1700
7TH GRADE - SOCIAL STUDIES AND MATH	2	850	1700
SCIENCE LAB	1	1,000	1000
8TH GRADE CLASSROOMS			
8TH GRADE - READING AND WRITING	2	850	1700
8TH GRADE - SOCIAL STUDIES AND MATH	2	850	1700
SCIENCE LAB	1	1,000	1000
ACADEMIC SUPPORT			
MULTI-USE FLEX LEARNING	3	400	1200
SMALL GROUP LEARNING	3	150	450
INSTRUCTIONAL MATERIAL STORAGE	3	120	360
SCIENCE LAB PREP/STORAGE	3	120	360
LEARNING STAIR / COMMONS PRESENTATION	0	1,500	0
TOTAL ACADEMIC CORE			15,570

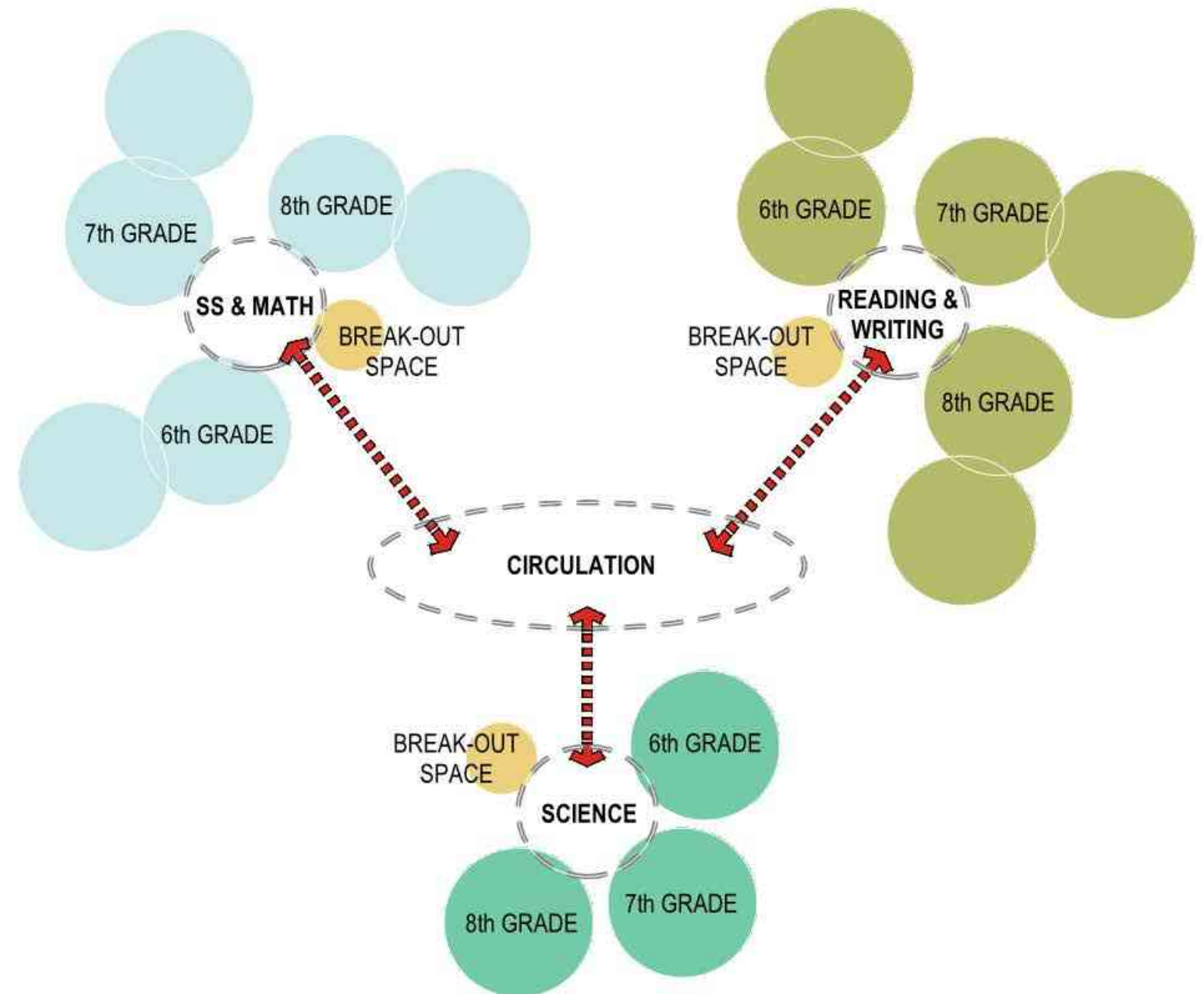

CLASSROOM ORGANIZATION BY GRADE

LEGEND

-  PRIMARY / DIRECT CONNECTION
-  SECONDARY CONNECTION
-  READING & WRITING
-  SOCIAL STUDIES & MATH
-  SCIENCE

DEPARTMENT / PROGRAM	NUMBER SIMILAR ROOMS	NET AREA	TOTAL AREA
ACADEMIC CORE			
6TH GRADE CLASSROOMS			
6TH GRADE - READING AND WRITING	2	850	1700
6TH GRADE - SOCIAL STUDIES AND MATH	2	850	1700
SCIENCE LAB	1	1,000	1000
7TH GRADE CLASSROOMS			
7TH GRADE - READING AND WRITING	2	850	1700
7TH GRADE - SOCIAL STUDIES AND MATH	2	850	1700
SCIENCE LAB	1	1,000	1000
8TH GRADE CLASSROOMS			
8TH GRADE - READING AND WRITING	2	850	1700
8TH GRADE - SOCIAL STUDIES AND MATH	2	850	1700
SCIENCE LAB	1	1,000	1000
ACADEMIC SUPPORT			
MULTI-USE FLEX LEARNING	3	400	1200
SMALL GROUP LEARNING	3	150	450
INSTRUCTIONAL MATERIAL STORAGE	3	120	360
SCIENCE LAB PREP/STORAGE	3	120	360
LEARNING STAIR / COMMONS PRESENTATION	0	1,500	0
TOTAL ACADEMIC CORE			15,570

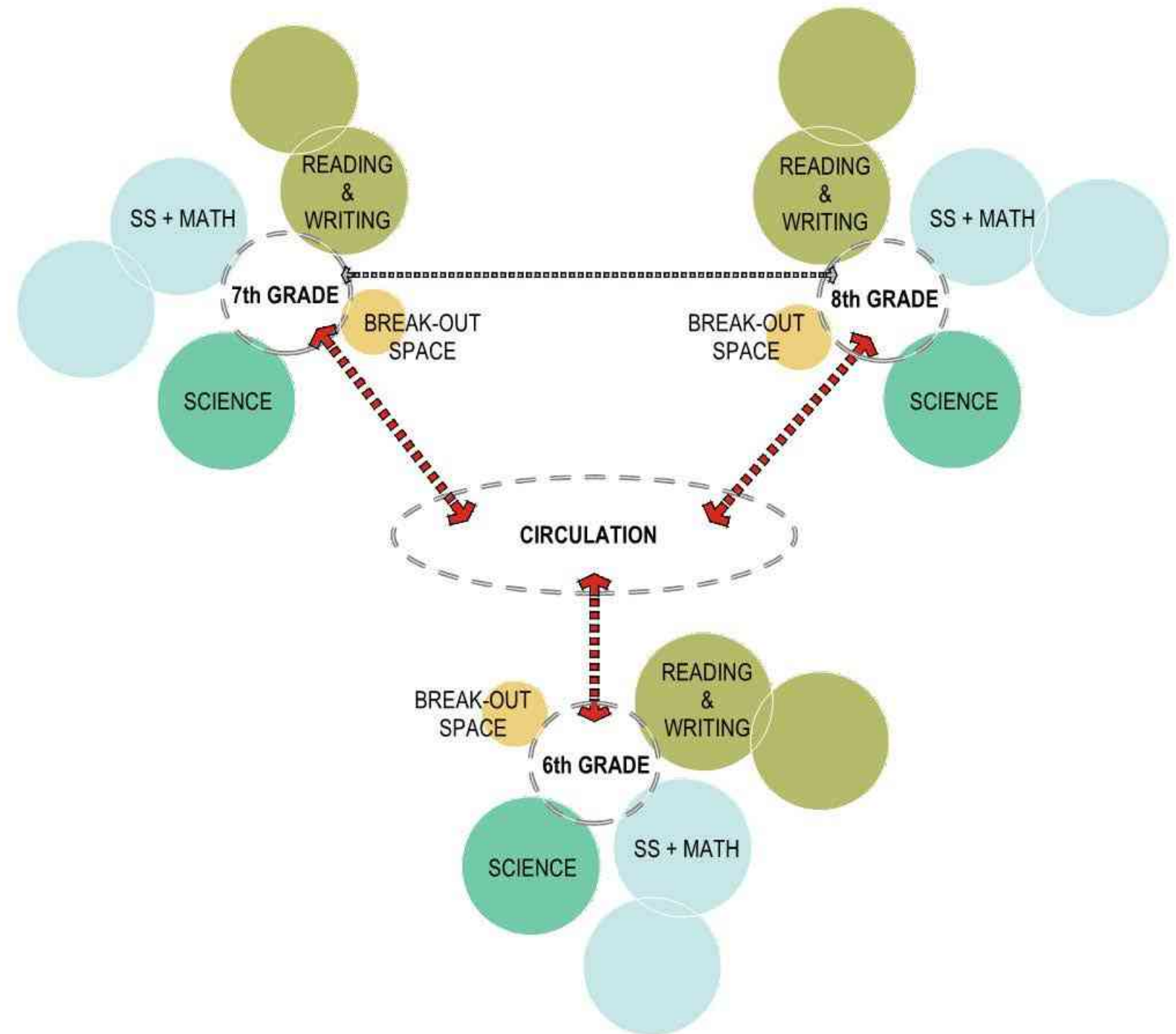

CLASSROOM ORGANIZATION BY TRACK

LEGEND

PRIMARY / DIRECT CONNECTION

SECONDARY CONNECTION

READING & WRITING

SOCIAL STUDIES & MATH

SCIENCE

DEPARTMENT / PROGRAM	NUMBER SIMILAR ROOMS	NET AREA	TOTAL AREA
ACADEMIC CORE			
6TH GRADE CLASSROOMS			
6TH GRADE - READING AND WRITING	2	850	1700
6TH GRADE - SOCIAL STUDIES AND MATH	2	850	1700
SCIENCE LAB	1	1,000	1000
7TH GRADE CLASSROOMS			
7TH GRADE - READING AND WRITING	2	850	1700
7TH GRADE - SOCIAL STUDIES AND MATH	2	850	1700
SCIENCE LAB	1	1,000	1000
8TH GRADE CLASSROOMS			
8TH GRADE - READING AND WRITING	2	850	1700
8TH GRADE - SOCIAL STUDIES AND MATH	2	850	1700
SCIENCE LAB	1	1,000	1000
ACADEMIC SUPPORT			
MULTI-USE FLEX LEARNING	3	400	1200
SMALL GROUP LEARNING	3	150	450
INSTRUCTIONAL MATERIAL STORAGE	3	120	360
SCIENCE LAB PREP/STORAGE	3	120	360
LEARNING STAIR / COMMONS PRESENTATION	0	1,500	0
TOTAL ACADEMIC CORE			15,570

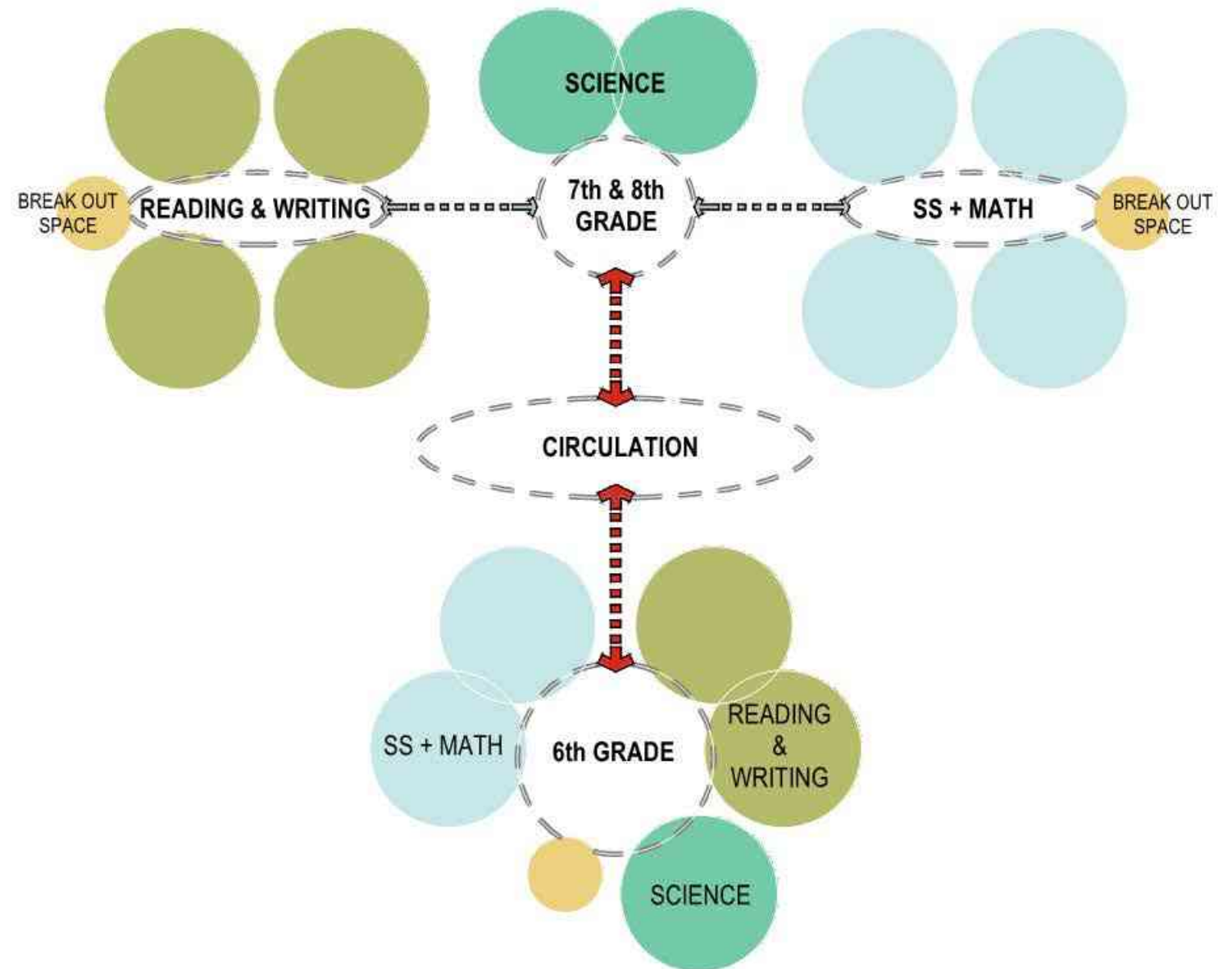

SPECIAL EDUCATION

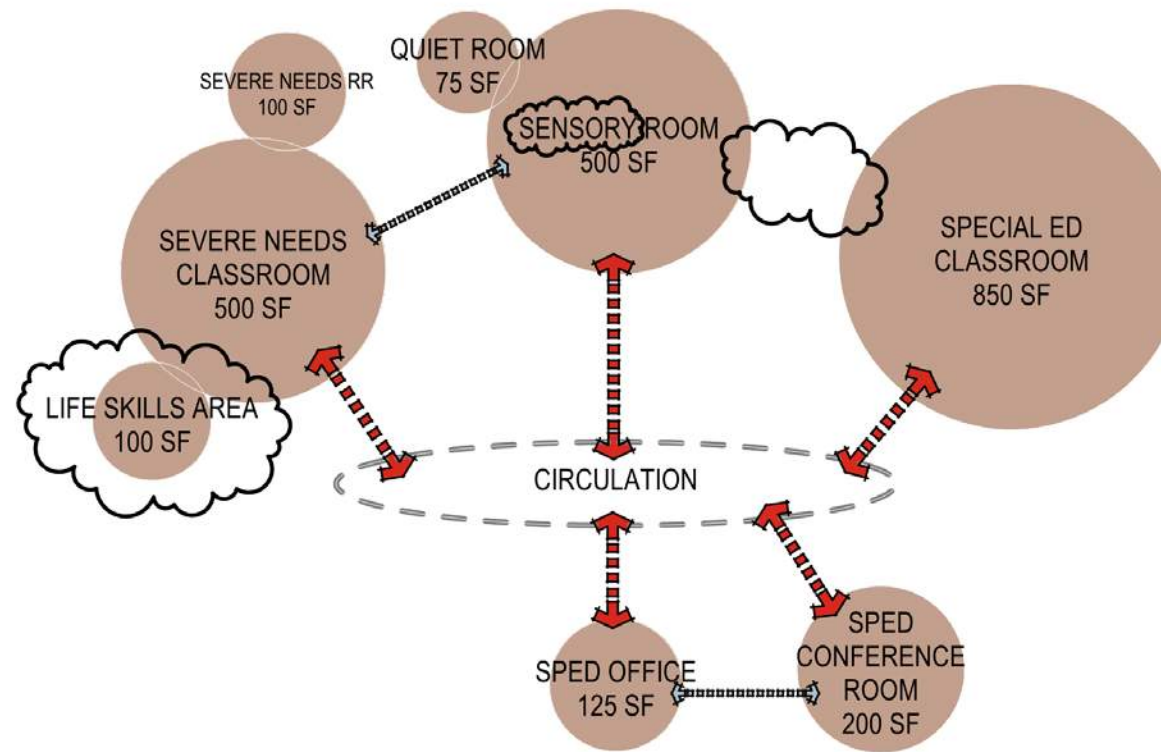
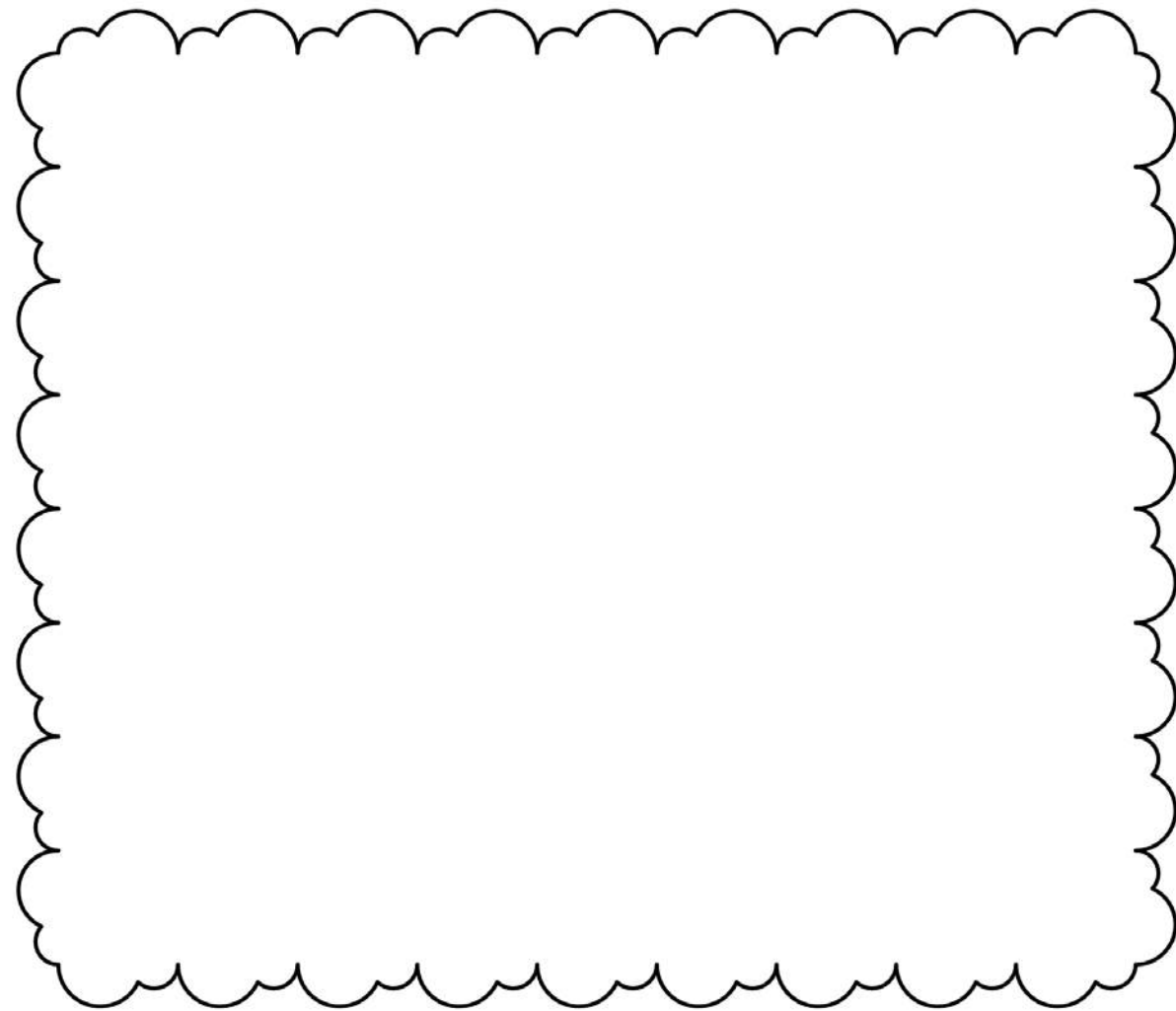

SPECIAL EDUCATION - OPTION B

1/16" = 1'-0"

Regardless of option chosen, the Special Ed program needs to be centrally based among the grades/teams

DEPARTMENT / PROGRAM	NUMBER SIMILAR ROOMS	NET AREA	TOTAL AREA
SPECIAL EDUCATION			
SPECIAL ED CLASSROOM CLASSROOM	1	850	850
SEVERE NEEDS CLASSROOM	1	500	500
SEVERE NEEDS RESTROOM	1	100	100
OT/PT ROOM	1	500	500
LIFE SKILLS AREA	1	100	100
QUIET ROOM	1	75	75
SPED CONFERENCE ROOM	1	200	200
SPED OFFICE	1	125	125
TOTAL SPECIAL EDUCATION			2,450

LEGEND

- PRIMARY / DIRECT CONNECTION
- SECONDARY CONNECTION

LIBRARY / TECH / CAREER AND TECH ED

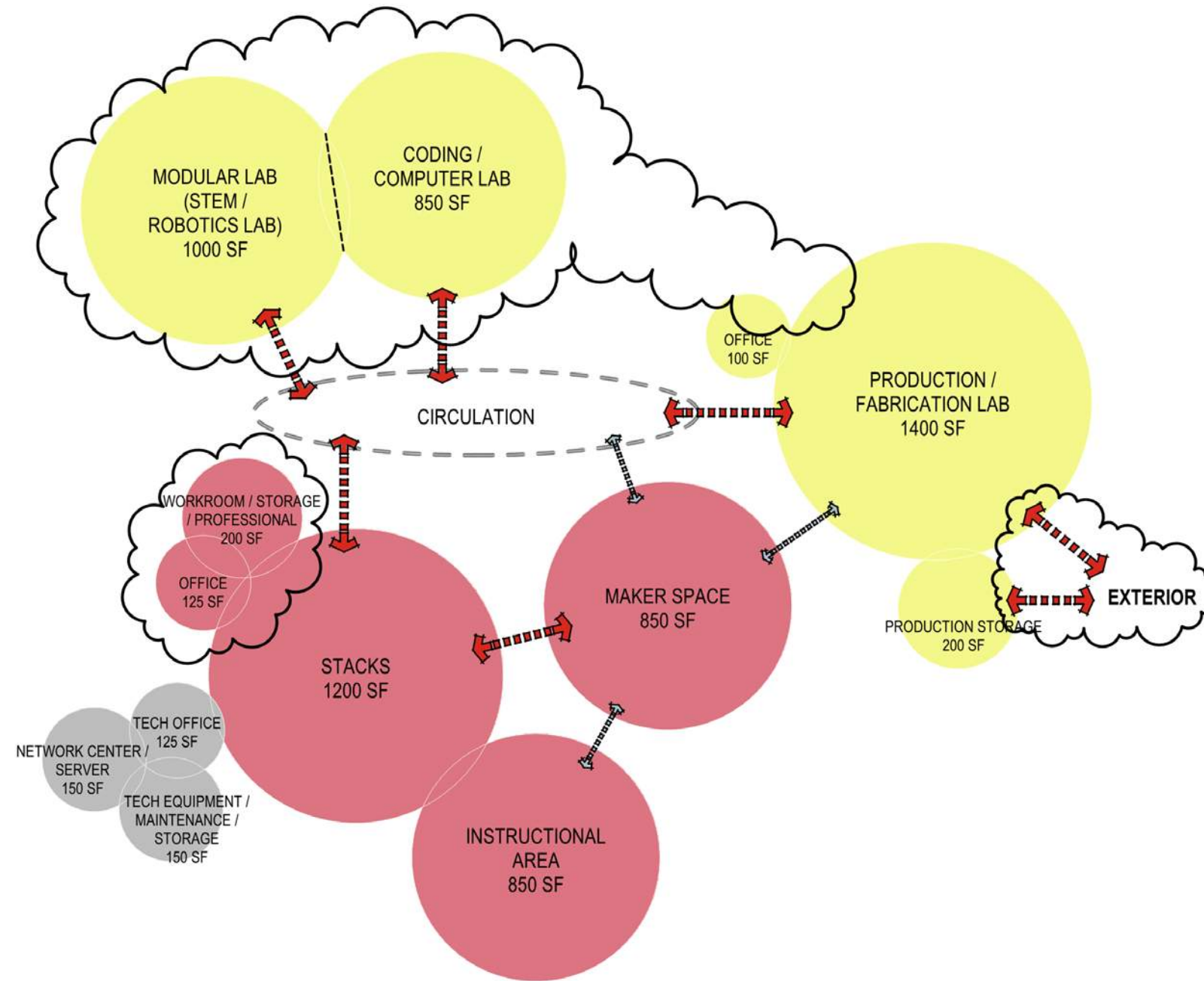

LEGEND

- PRIMARY / DIRECT CONNECTION
- SECONDARY CONNECTION

DEPARTMENT / PROGRAM	NUMBER SIMILAR ROOMS	NET AREA	TOTAL AREA
LIBRARY / TECHNOLOGY			
LIBRARY			
STACKS	1	1,200	1200
INSTRUCTIONAL AREA	1	850	850
MAKER SPACE	1	850	850
OFFICE	1	125	125
WORKROOM / STORAGE / PROFESSIONAL	1	200	200
TECHNOLOGY SUPPORT			
OFFICE	1	125	125
TECH EQUIPMENT MAINTENANCE / STORAGE	1	150	150
NETWORK CENTER / SERVER ROOM	1	150	150
TOTAL LIBRARY / TECHNOLOGY			3,650
CAREER AND TECHNICAL EDUCATION			
MODULAR LAB (STEM / ROBOTICS LAB)	1	1,000	1000
CODING LAB / COMPUTER LAB	1	850	850
PRODUCTION/FABRICATION LAB	1	1,400	1400
PRODUCTION STORAGE	1	200	200
OFFICE	1	100	100
TOTAL CAREER AND TECHNICAL ED			3,550

FINE AND PERFORMING ARTS

DEPARTMENT / PROGRAM	NUMBER SIMILAR ROOMS	NET AREA	TOTAL AREA
FINE AND PERFORMING ARTS			
VISUAL ARTS			
2D/3D ART ROOM	1	1,500	1500
KILN ROOM	1	150	150
STORAGE ROOM	1	200	200
OFFICE	1	100	100
PERFORMING ARTS : MUSIC			
VOCAL MUSIC ROOM	0	1,200	0
INSTRUMENTAL MUSIC ROOM	1	1,600	1600
INSTRUMENTAL STORAGE	1	200	200
OFFICE	1	100	100
PERFORMING ARTS : THEATER			
DRAMA CLASSROOM	0	850	0
AUDITORIUM			0
STAGE			0
DRESSING ROOMS			0
DRAMA STORAGE			0
TOTAL FINE AND PERFORMING ARTS			3,850

LEGEND

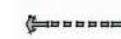
-  PRIMARY / DIRECT CONNECTION
-  SECONDARY CONNECTION

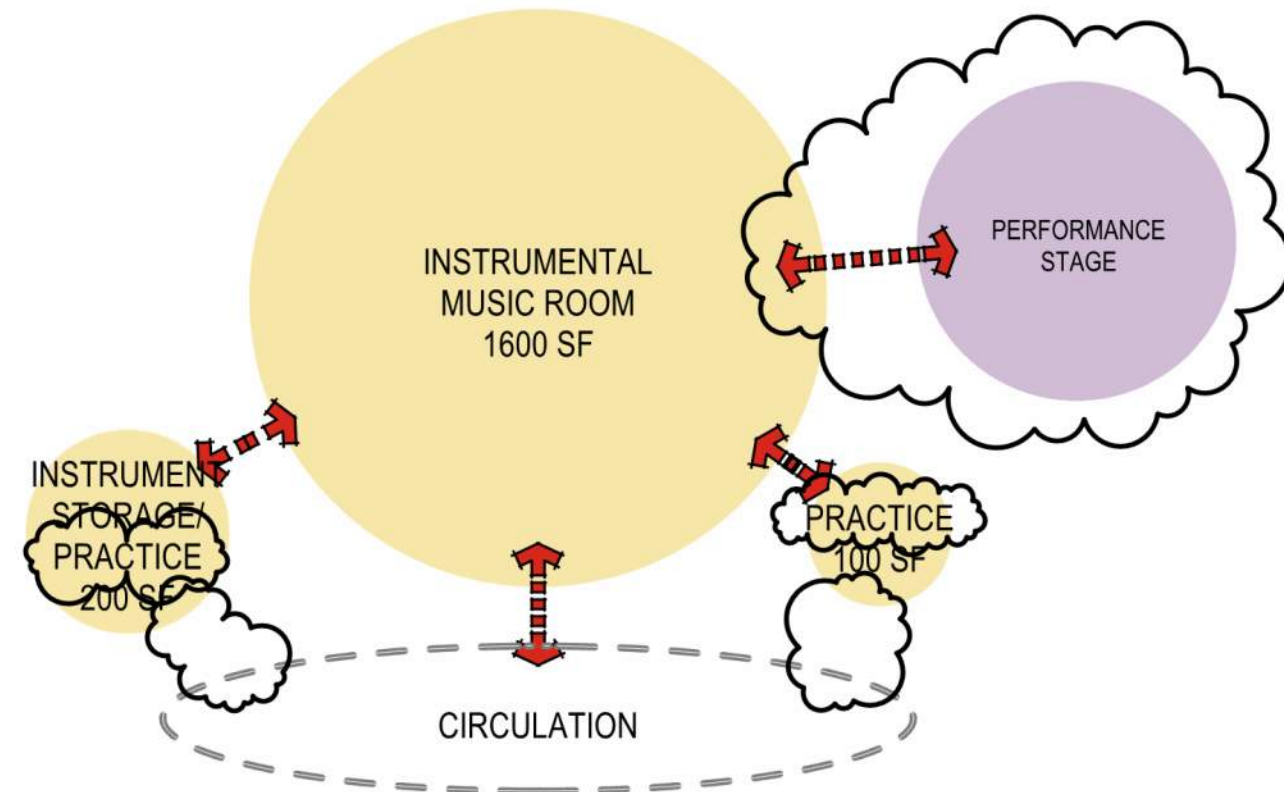
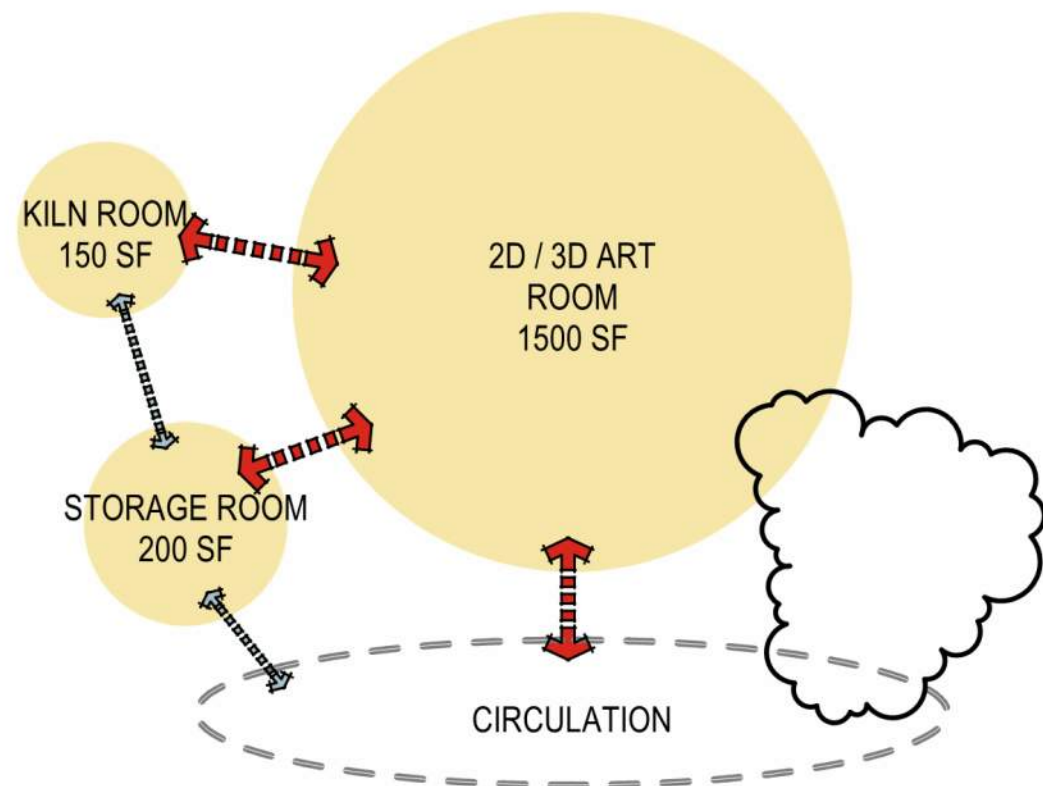

PHYSICAL ED , HEALTH , & ATHLETICS OPTION 1

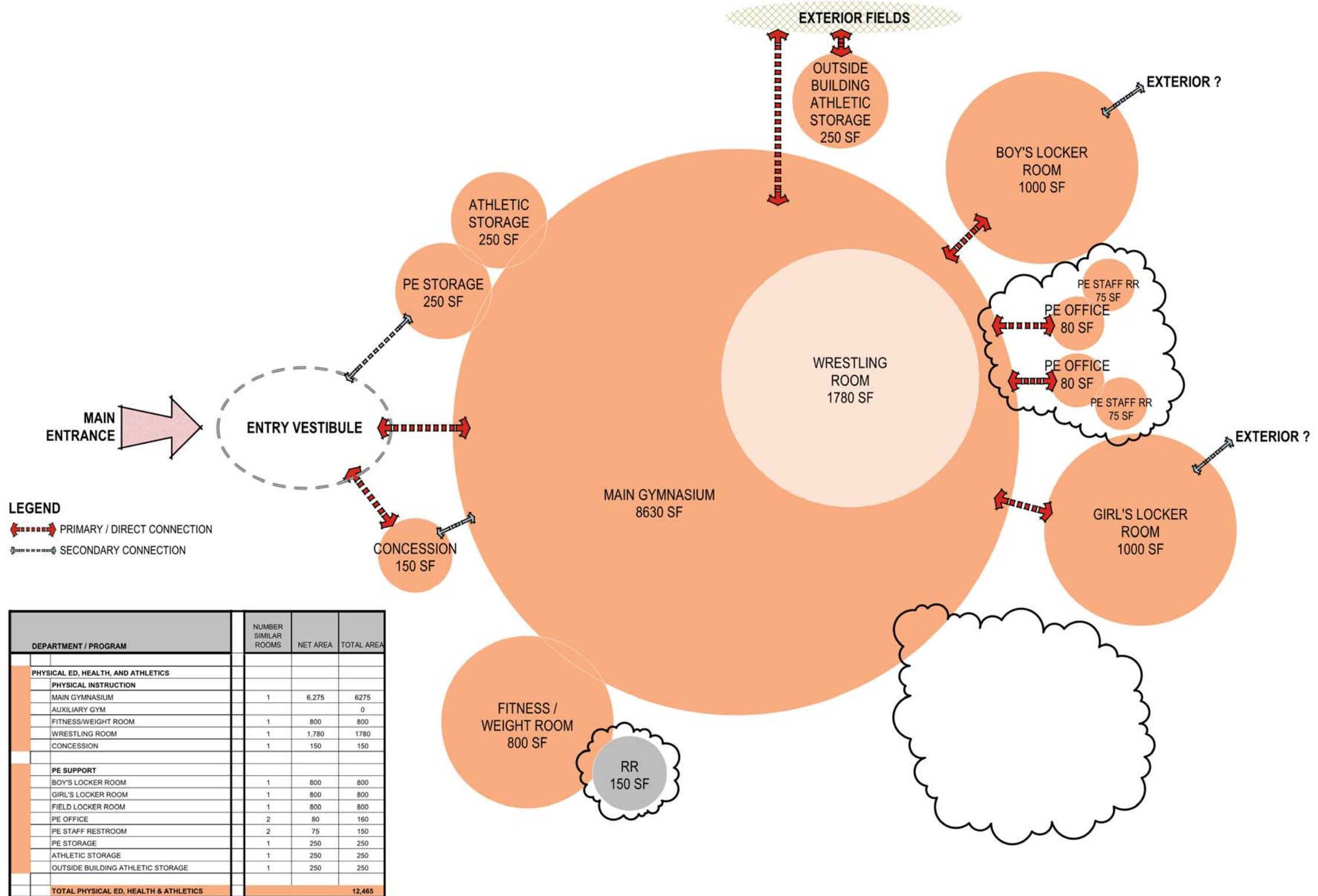

SITE ANALYSIS

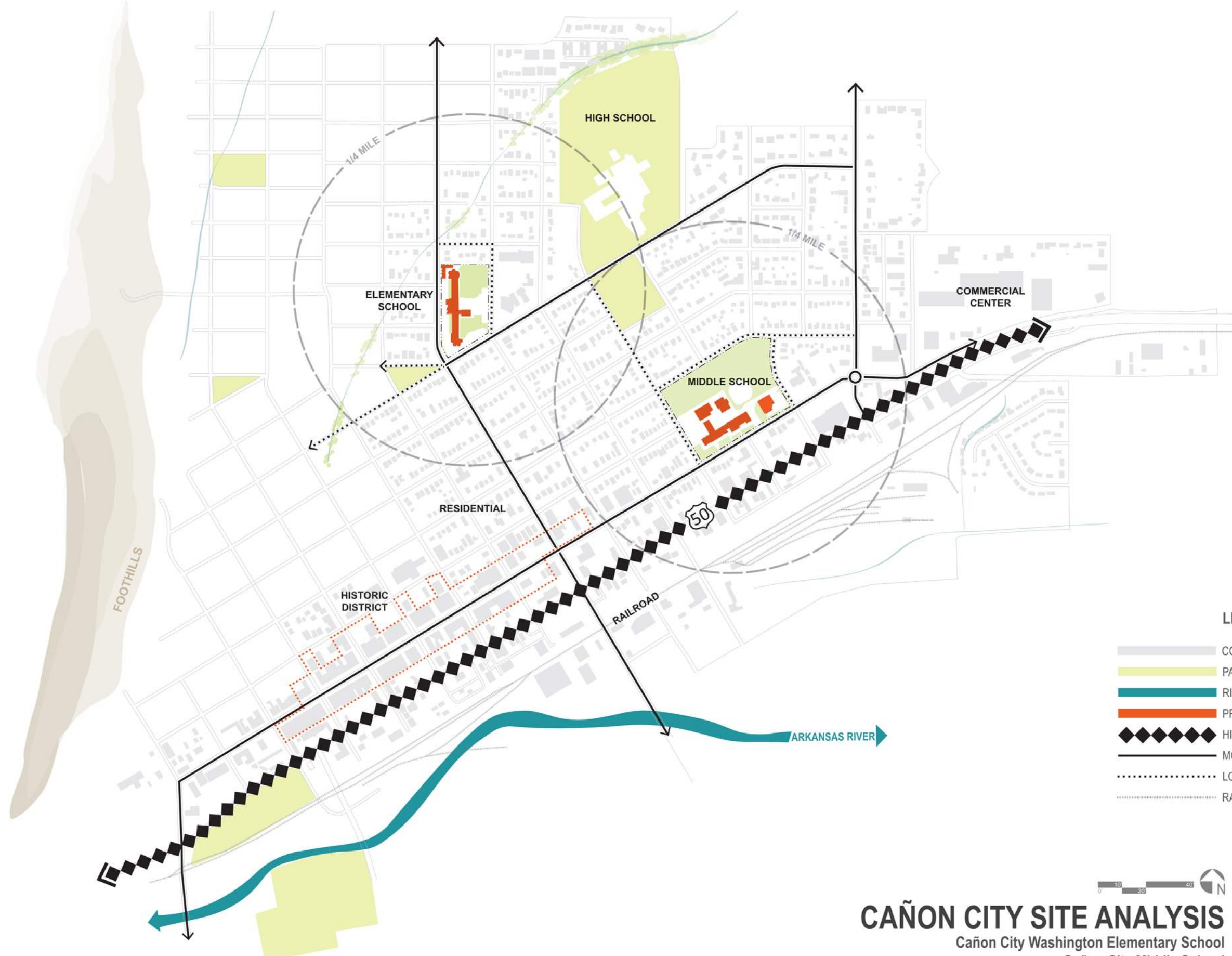

LEGEND

- CONTEXT BUILDINGS
- PARK / GREENSPACE
- RIVER / STREAM
- PROJECT SITE
- HIGH TRAFFIC
- MODERATE TRAFFIC
- LOW TRAFFIC
- RAILROAD



CAÑON CITY SITE ANALYSIS

Cañon City Washington Elementary School
 Cañon City Middle School



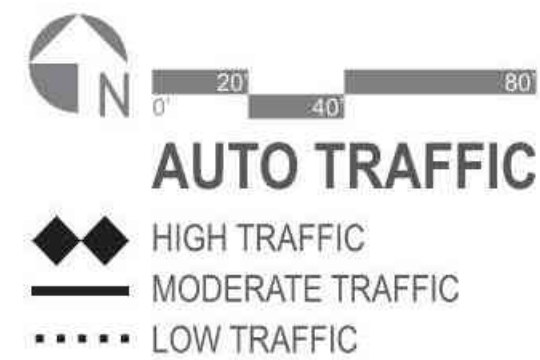
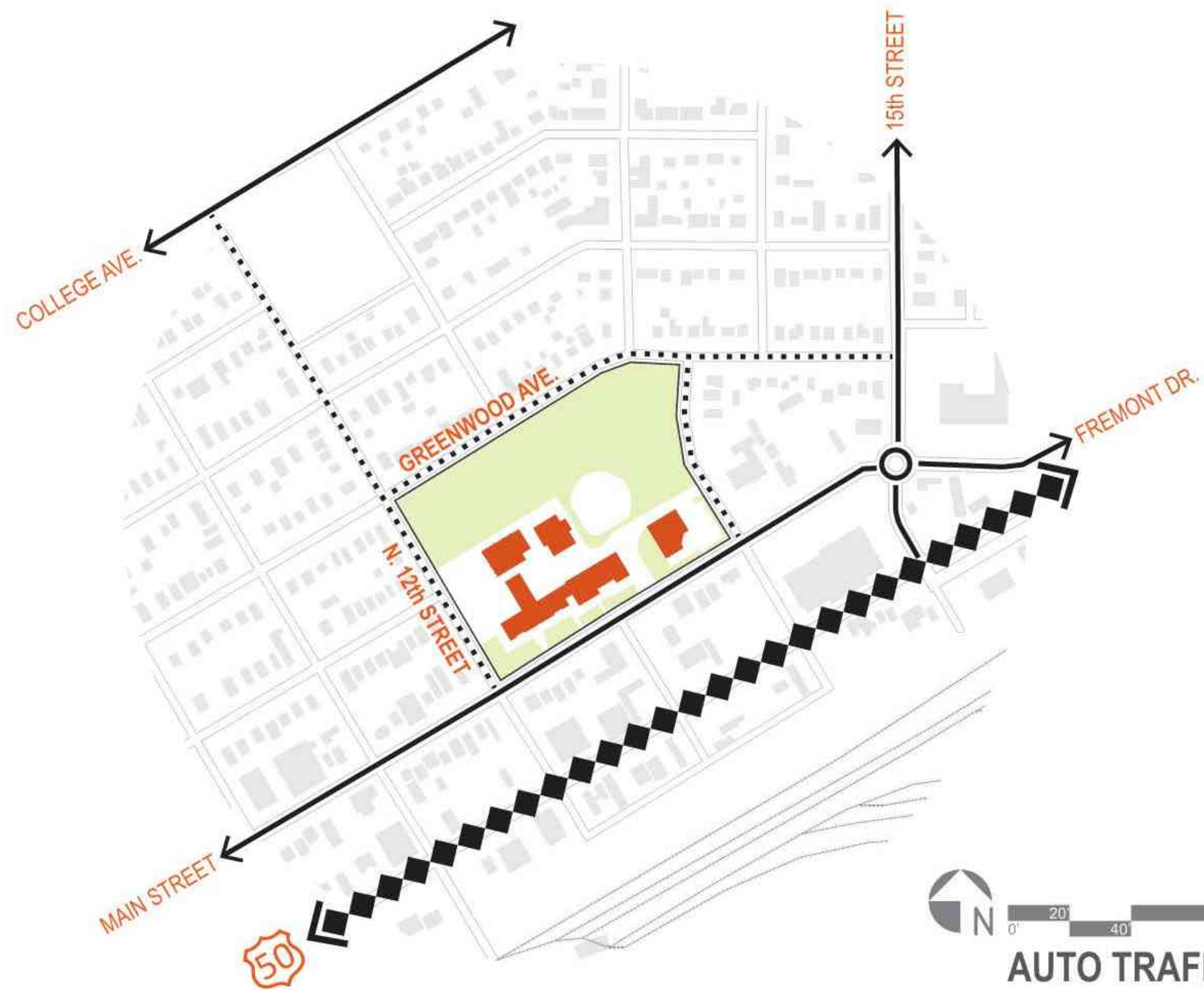



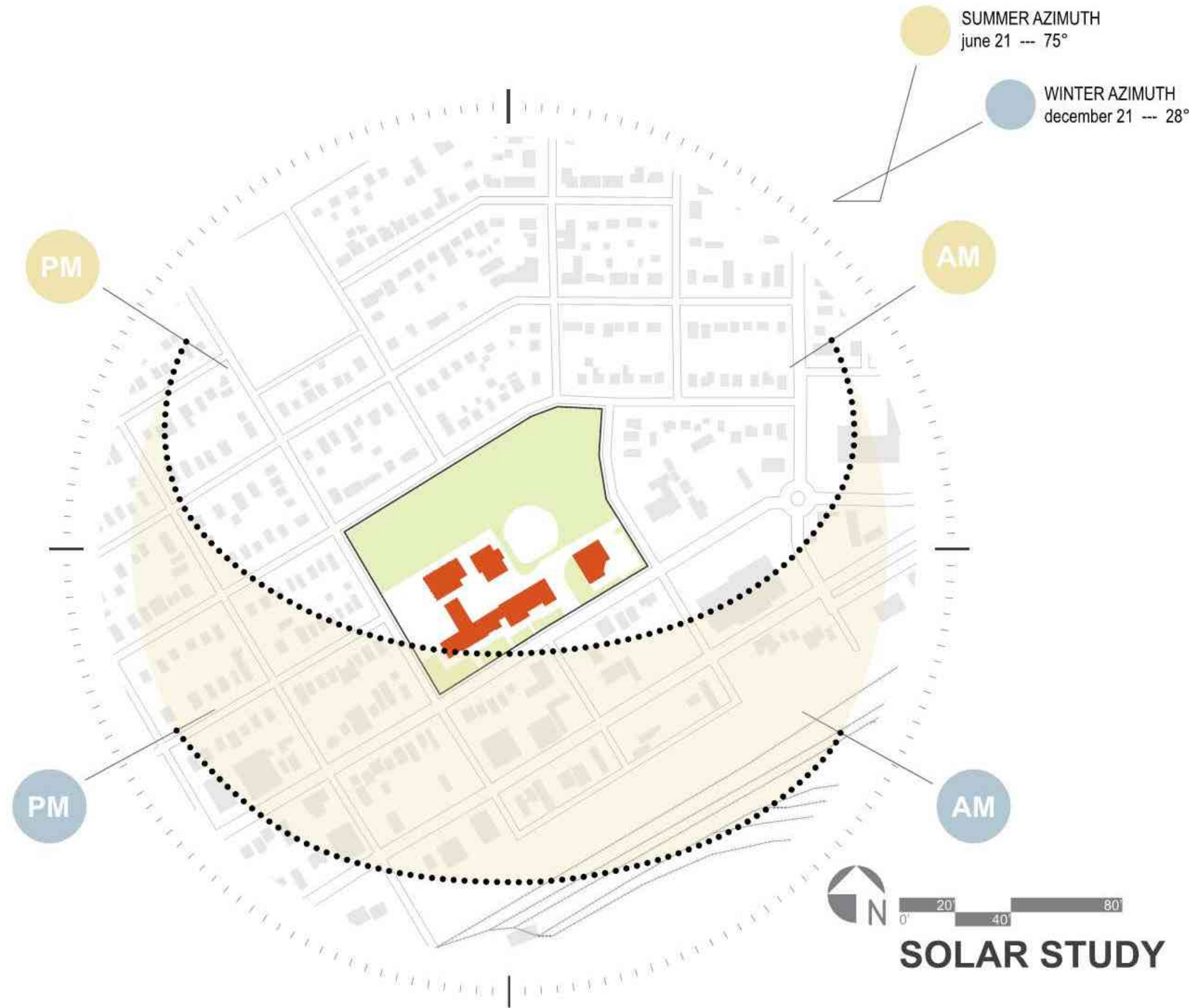

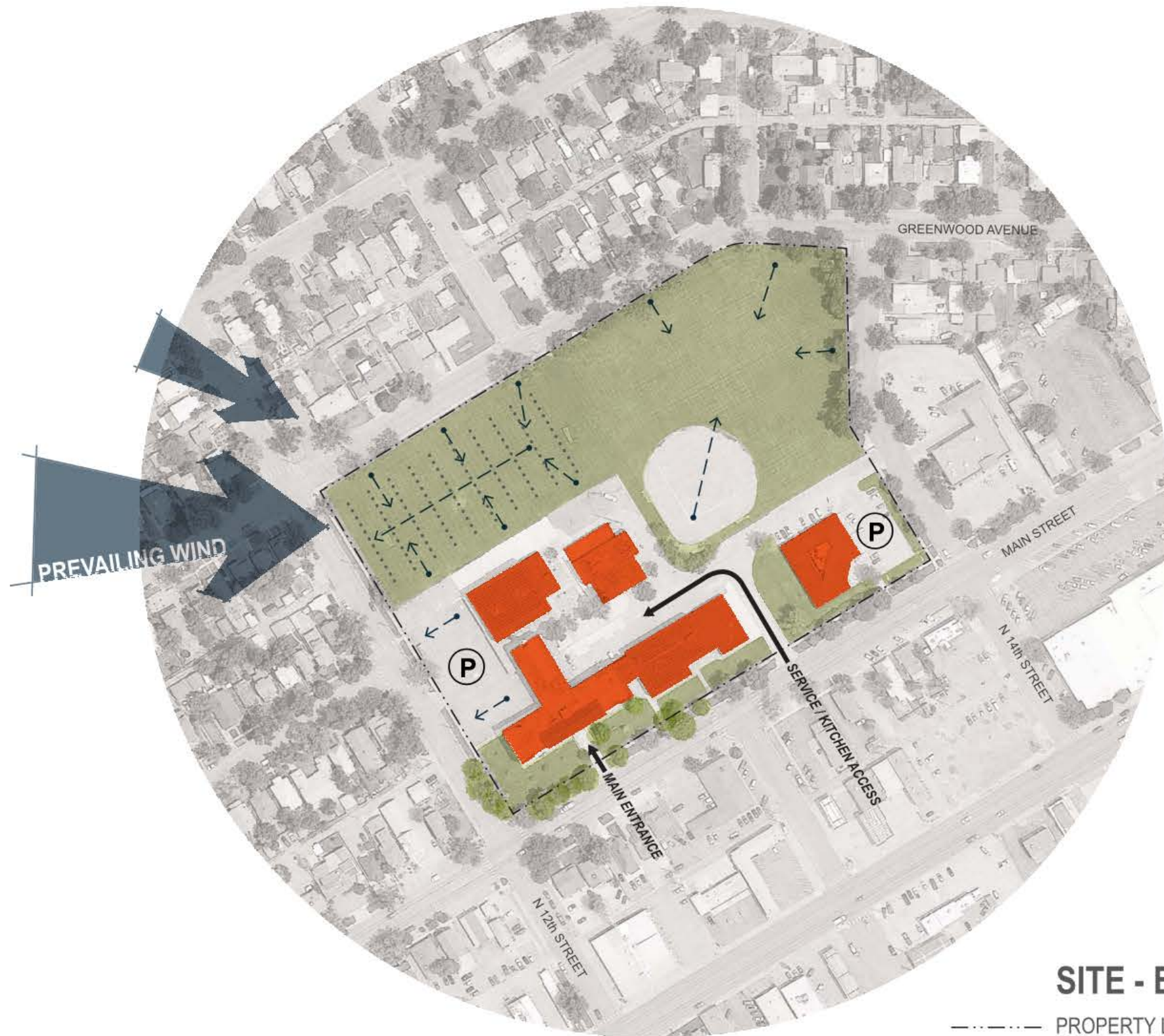

SITE - EXISTING CONDITIONS

- PROPERTY LINE
- GEOTHERMAL PIPING
- ←→ DRAINAGE
- ← ACCESS
- ← PREVAILING WIND
- Ⓟ ON-SITE PARKING





8:00 am

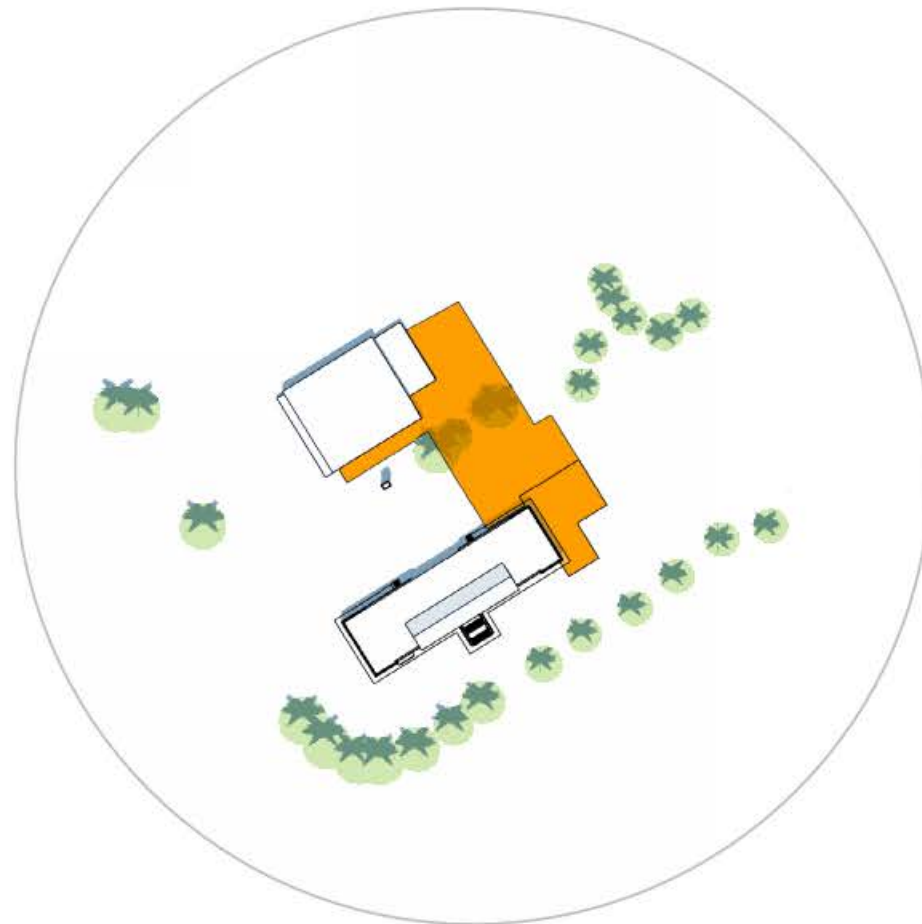

12:00 pm

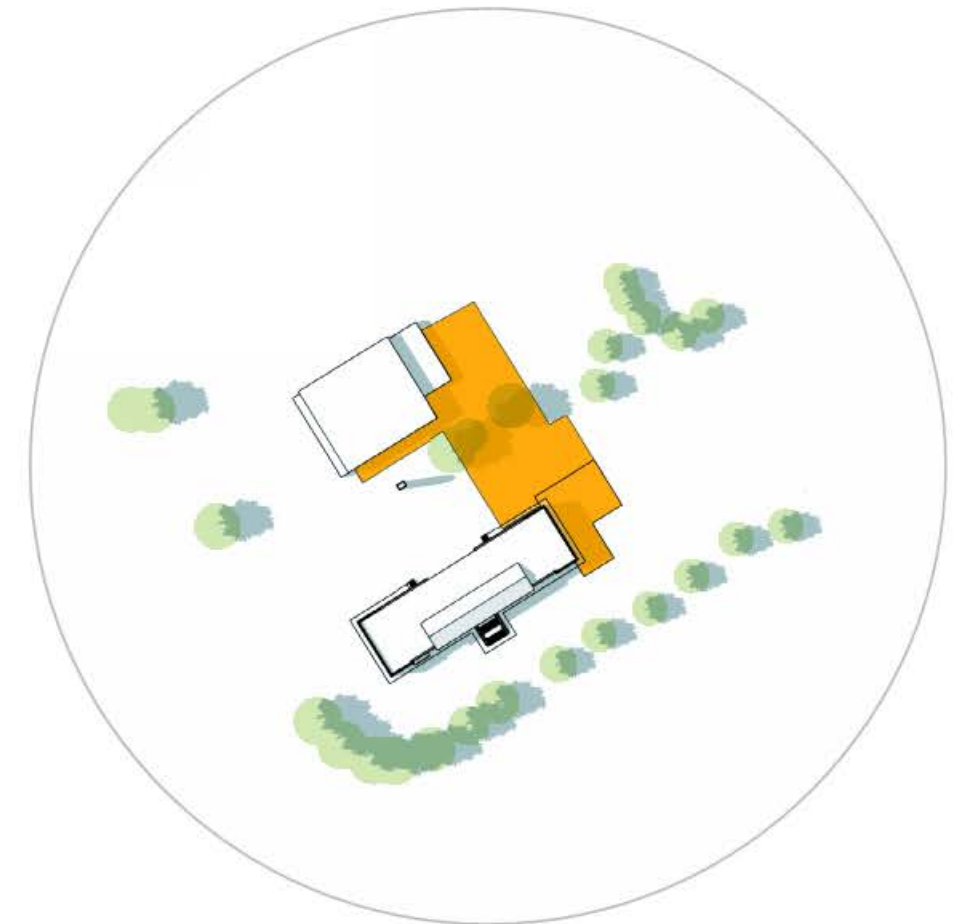

3:00 pm

SUMMER SOLSTICE - june 21st





8:00 am



12:00 pm



3:00 pm

WINTER SOLSTICE - december 21st



EXISTING BUILDING SECTION

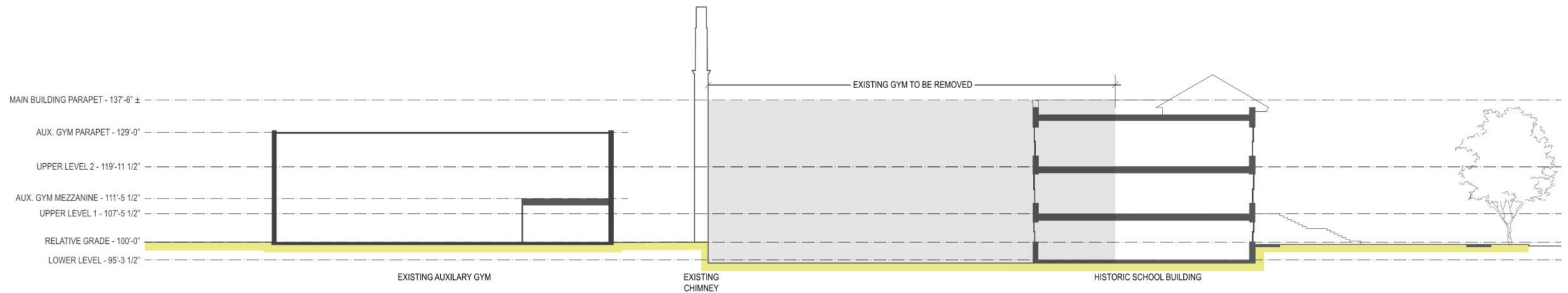

PARTI DIAGRAM

CONCEPT A



MAIN LEVEL & LOWER LEVEL OF HISTORIC BUILDING

UPPER LEVEL 1 - HISTORIC BUILDING

CONCEPT A



UPPER LEVEL 2



CONCEPT B



MAIN LEVEL & LOWER LEVEL OF HISTORIC BUILDING

UPPER LEVEL 1 - HISTORIC BUILDING

CONCEPT B

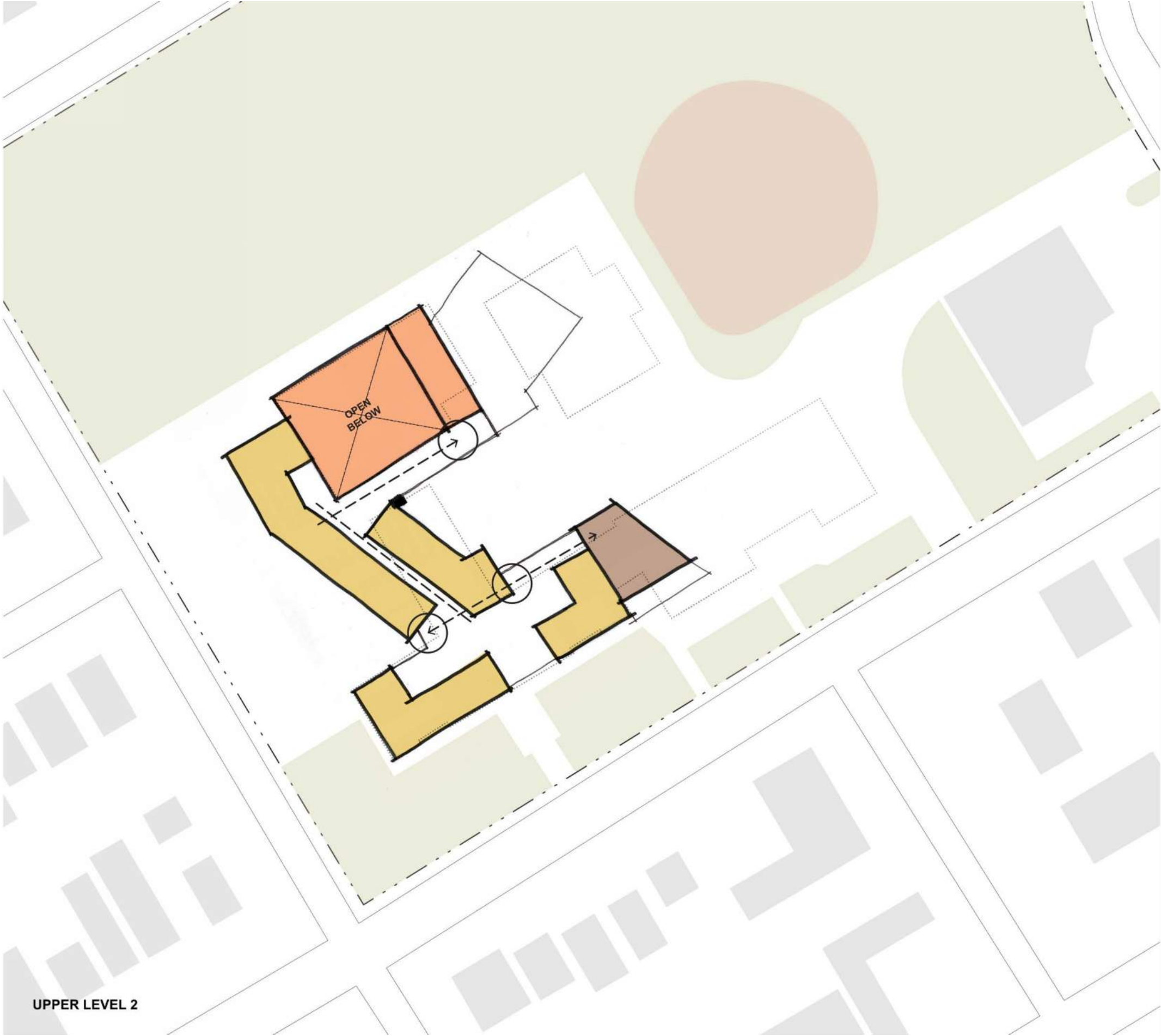

UPPER LEVEL 2



CONCEPT C



MAIN LEVEL & LOWER LEVEL OF HISTORIC BUILDING

UPPER LEVEL 1 - HISTORIC BUILDING

CONCEPT C

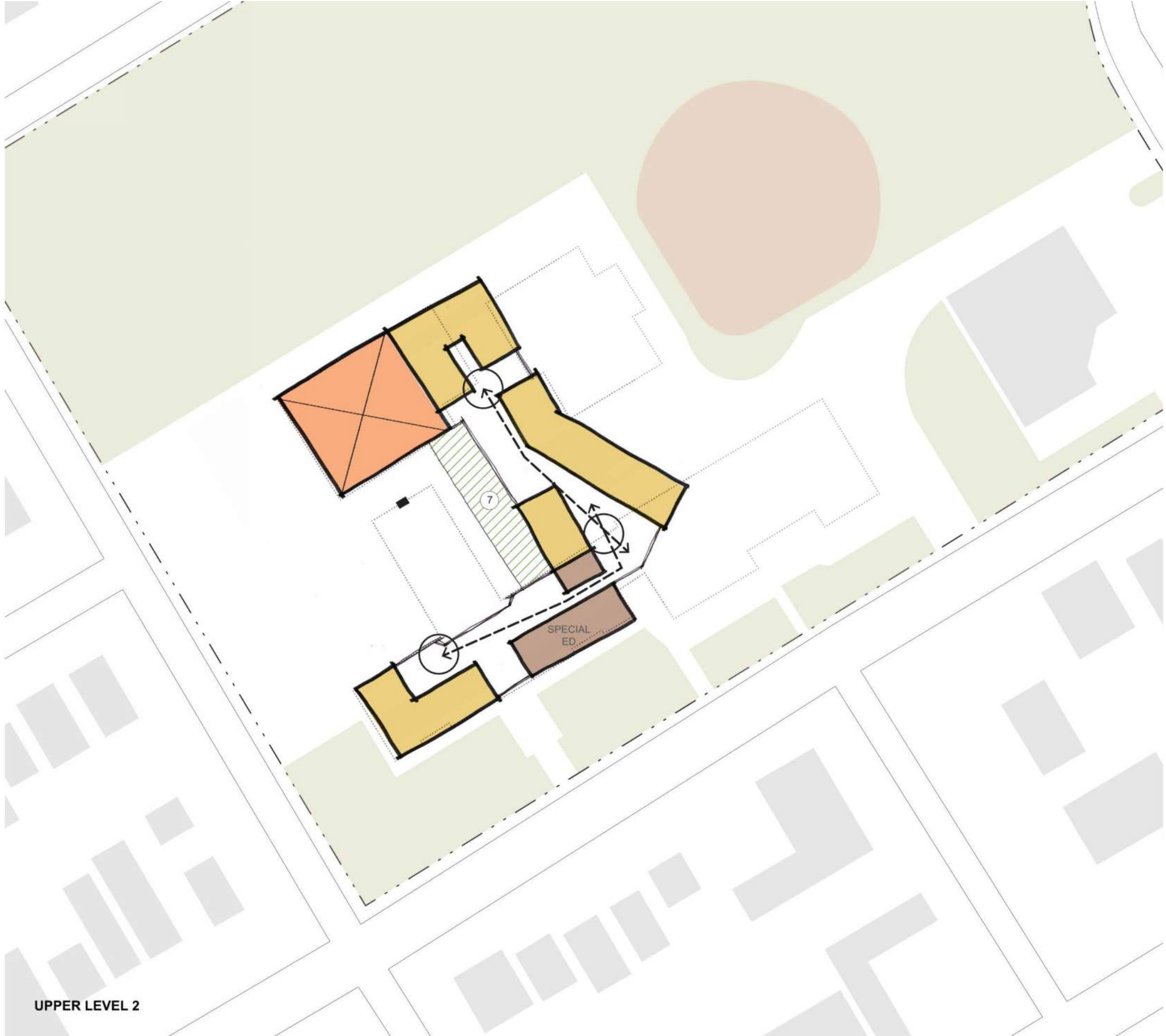

UPPER LEVEL 2



SITE PARTI ACTIVITY QUESTIONS

1. location of the Commons/Courtyard?
2. Commons/courtyard relationship to the bus and parent drop off areas?
3. Admin/entry/community health relationships?
4. Stage/Commons or stage/gym relationship?
5. Distribution of the classroom environment?
6. Potential problem?
7. Potential strengths?

Next DAG Meeting

Tuesday, October 2nd, 3:15-5:15pm

Agenda Items

1. Refinement of selected parti
2. Conceptual floor plan discussions

Homework:

1. No homework!